

Y

GOVERNMENT HOUSES

1908-1909.

Name and Situation	Number and size of			What is the heating and lighting arrangement and at whose cost?	Amount and description of	
	Reception Rooms	Family Rooms	Servants' Rooms		Land	Garden
Valletta Palace ... ..	<p>No. 8 Ante Room 35'-4" × 33'-1"</p> <p>No. 9 State Drawing Room 35'-10" × 35'-2"</p> <p>No. 10 Ball Room 85'-2" × 37'-3"</p> <p>No. 11 Dining Room 66'-10" × 28'-6"</p> <p>No. 12 Day Room 17'-3" × 16'-10"</p> <p>No. 13 Day Room 17' × 16'-4"</p> <p>No. 14 Private Drawing Room 45'-4" × 20'-9"</p>	<p>No. 1 Spare Room 27'-4" × 17'-8"</p> <p>No. 2 Spare Room 28' × 18'</p> <p>No. 4 Spare Room 23'-7" × 19'-2"</p> <p>No. 15 His Excellency's Room 24'-2" × 21'-5"</p> <p>No. 16 His Excellency's Room 25' × 20'-4"</p> <p>No. 17 His Excellency's Room 24'-10" × 20'-8"</p> <p>No. 24 Spare Room 24' × 19'-3"</p> <p>No. 25 Spare Room 24' × 19'-10"</p> <p>No. 26 Spare Room 24' × 19'-6"</p> <p>No. 28 A.D.C.'s Room 27'-11" × 18'-11"</p> <p>No. 30 A.D.C.'s Room 29'-4" × 17'-9"</p> <p>No. 31 A.D.C.'s Room 32'-11" × 12'-2"</p> <p>No. 29 A.D.C.'s Room 21'-9" × 15'-9"</p>	<p>No. 22 One Room 18'-6" × 13'-5"</p> <p>No. 23 One Room 18' × 13'-6"</p> <p>No. 32 A.C.D.'s Servants' Room 19'-10" × 9'-7"</p> <p>No. 33 One Room 21'-2" × 14'-3"</p> <p>No. 34 One Room 20'-6" × 14'-2"</p> <p>No. 35 One Room 23'-9" × 14'-3"</p> <p>No. 36 Steward's Quarters</p> <p>Messenger's Quarters</p> <p>Fatiguelman's Quarters</p> <p>a. Coachman's Quarters</p>	<p>Heating by coals which are supplied at the Governor's expense. Lighting by Electricity at a cost of £ 200. 7. 8 a year, of which £ 170. 7. 8 is paid by Government and £ 30 by the Governor.</p>	Nil.	Nil.

## RESIDENCES BY THE GOVERNOR.

Number of Labourers and Gardeners required	Any expenses necessarily borne by Governor in 1908-9	Furniture				Other information useful for a new Governor
		If supplied by Colonial Government	Percentage annually payable	Is plate, Linen, Crockery, Glass supplied by Colonial Government?	Percentage payable	
The only Gardener employed for cultivating the Palace Yards is paid by the Colonial Government.	Nil.	Yes.	5 <sup>0</sup> / <sub>100</sub> on certain amount	Plate, table-linen, crockery, glass and kitchen utensils are supplied by Colonial Government.	5 <sup>0</sup> / <sub>100</sub>	Besides this Palace, the Governor enjoys also the use of other two Palaces (St. Antonio and Verdala) which may be considered as summer Resorts.

Name and Situation	Number and size of			What is the heating and lighting arrangement and at whose cost?	Amount and description of	
	Reception Rooms	Family Rooms	Servants' Rooms		Land	Garden
St. Antonio Palace and Gardens within the limits of Casal Attard.	No. 14 Dining Room 39'-5" X 26'-6"	No. 1 His Excellency's Room 21' X 17'-4"	No. 26 Upper floor One Room 21'-1" X 19'	Heating is obtained by means of Iron coal Stoves, and Lighting by Electricity all at the expense of the Governor.	Kitchen-garden on the other side of the road of the extent of Acres. 2. 0. 35.	Public Gardens of the extent of 15 acres. Private Gardens of 4½ acres.
	No. 16 Billiard Room 34'-4" X 24'-4"	No. 2 His Excellency's Room 22'-7" X 21'-8"	No. 28 One Room 15'-4" X 11'-1"			
	No. 21 Drawing Room 35'-6" X 27'-9"	No. 3 Spare Room 21'-11" X 18'-3"	No. 29 One Room 15'-2" X 11'			
		No. 4 Spare Room 22' X 19'-2"	No. 30 One Room 19'-2" X 15'-11"			
		No. 5 Bed Room 30' X 14'-3"	No. 31 One Room 19' X 10'-4"			
		No. 6 Spare Room 21'-5" X 14'-3"	No. 32 One Room 18'-10" X 16'-1"			
		No. 7 Spare Room 19' X 17'-10"	No. 33 One Room 10'-6" X 9'-2"			
		No. 8 Spare Room 20'-5" X 18'	No. 34 One Room 10'-5" X 9'-3"			
		No. 9 A.D.C.'s Room 24'-6" X 22'-5"	No. 35 One Room 18'-8" X 15'-10"			
		No. 12 A.D.C.'s Room 25'-6" X 24'-1"	No. 36 One Room 13'-5" X 10'			
		No. 18 Spare Room 24'-2" X 21'-11"	No. 37 One Room 17' X 14'-1"			
		No. 20 Spare Room 30'-10" X 24'-4"	Ground floor No. 39 Spare Room 21'-10" X 18'-3"			
		No. 22 (Tower) A.D.C.'s Room 30'-1" X 14'-1"	No. 44 Custodian's Quarters			
		No. 24 (Tower) Spare Room 30' X 14'-3"				

## RESIDENCES BY THE GOVERNOR.

Number of Labourers and Gardeners required	Any expenses necessarily borne by Governor in 1908-9	Furniture			Other information useful for a new Governor		
		If supplied by Colonial Government	Percentage annually payable	Is plate, Linen, Crockery, Glass supplied by Colonial Government?		Percentage payable	
<p>IN PUBLIC GARDENS.</p> <p>Five Gardeners and 10 Labourers and Apprentices and one Policeman, paid out of the Colonial Funds.</p> <p>IN PRIVATE GARDENS.</p> <p>Three Gardeners, 3 Labourers and 1 Cartman paid out of the Colonial Funds.</p>	Nil.	Yes	5% on certain amount		5%	Independently of a kitchen-garden, used as such when required, its expenses being defrayed by the Governor, there exists at the Palace a Cow-house, where a Cow-man is employed, paid also by the Governor.	
				Plate, table-linen, crockery, and glass are supplied by the Colonial Government.			

Name and Situation	Number and size of			What is the heating and lighting arrangement and at whose cost?	Amount and description of	
	Reception Rooms	Family Rooms	Servants' Rooms		Land	Garden
Verdala Palace situate $1\frac{1}{2}$ miles to the south, and within the limits of Notabile.	No. 4 A.D.C.'s Room 20' X 21'-3"	No. 1 Lady's Room 20' X 21'-9"	No. 8 Valet's Room 10' X 10'	Heating none—The lighting is by Acetylene Gas at the expense of the Governor.	NIL.	
	No. 5 Dining Room 45'-3" X 29'	No. 2 His Excellency's Room 20' X 21'-9"	No. 16 One Room 20'-10" X 24'-5"			
	No. 6 His Excellency's Study 20' X 21'-3"	No. 3 Spare Room 20' X 21'-7"	No. 17 One Room 11' X 11'			
	No. 7 Entrance Hall 29' X 17'	No. 10 Maid's Room 27' X 22'-9"	No. 21 Dining Room 34' X 15'-6"			
	No. 9 Boudoir 28'-3" X 19'-8"	No. 12 Spare Room 24'-8" X 21'-7"	No. 27 Butler's Room 20'-4" X 19'			
	No. 11 Drawing Room 48' X 29'	No. 13 Spare Room 24'-8" X 21'-6"	No. 29 Servants' Hall 19'-6" X 19'			
		No. 14 Spare Room 24'-6" X 20'-5"	F Cook's Room 17'-7" X 16'-9"			
		No. 15 Spare Room 24'-4" X 22'-5"	H One Room 20'-10" X 15'-3"			
			I One Room 20'-10" X 7'-4"			
			J One Room 21'-9" X 17'-4"			
			K One Room 21' X 8'-8"			
		O Groom's Room 21'-8" X 14'-10"				

## RESIDENCES BY THE GOVERNOR.

Number of Labourers and Gardeners required	Any expenses necessarily borne by Governor in 1908-9	Furniture				Other information useful for a new Governor
		If supplied by Colonial Government	Percentage annually payable	Is plate, Linen, Crockery, Glass supplied by Colonial Government?	Percentage payable	
Two Gardeners paid out of Colonial Funds.	Nil.	Yes.	5% on certain amount	Plate, table-linen, crockery, glass and kitchen utensils are supplied by the Colonial Government.	5%	

GOVERNOR'S PALACE — VALLETTA.

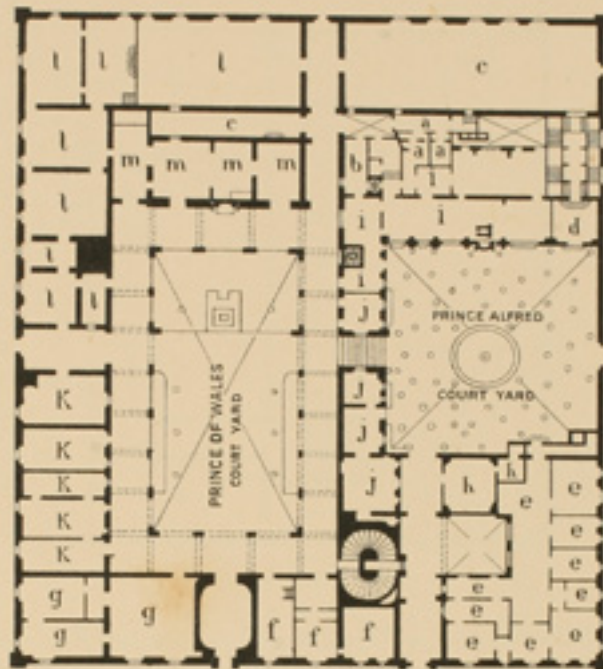

GROUND FLOOR.



- |    |                               |    |  |
|----|-------------------------------|----|--|
| a. | Coachman's Quarters.          | h. | Council Office.                          |
| b. | Harness Room.                 | i. | Printing Office.                         |
| c. | Stables and Coach House.      | j. | H. E. the Governor's Office (temporary). |
| d. | Staircase to Armoury.         | k. | Receiver General's Office.               |
| e. | Lieutenant Governor's Office. | l. | Public Works Office.                     |
| f. | Crown Advocate's Office.      | m. | Public Works Store Rooms.                |
| g. | R. M. Regt. Mess.             |    |  |



