

S.

GAOLS AND PRISONERS

1892.

## STATISTICAL RETURN, for the PRISONS of MALTA for 1892.

Name and Nature of the Prisons. (Mark "Lock-ups" not inserted).	Total number of Persons Committed in 1892.	Number Committed for Debt, Want of Fuel, and Punishment			Number of those Committed who have been Previously Convicted			Number of Persons Committed to Penal Imprisonment including "Hard Labour"				The daily average Number in Prison	The number of Admissions to Hospital during the year 1892	The Daily Average on the Sick List.	The number of deaths during 1892
		For Debt	For the sake of Custody, or for want of security	For purposes of Penal Imprisonment	Once	Twice	Three or more	For Five years or more	For one year or more, but less than Five Years	For more than Three Months, and less than One Year	For Three Months or less				
Corradino Prison (common Gaol).	1,453	6	29	1,418	197	189	1,067	12	49	72	1,285	212	15	7	2
Valletta Prison (Prison attached to the Police).	4,449	—	356	4,093	1,436	983	360	12	79	58	3,944	39	11	—	—
Gozo Prison (common Gaol).	1,185	—	44	1,141	213	107	631	1	4	4	1,132	9	—	—	—
Prison for Women in the Ospizio, Floriana } (common Gaol).	561	—	—	561	96	39	98	5	9	3	544	19	16	2	1
Total ...	7,648	6	429	7,213	1,942	1,318	2,156	30	141	137	6,905	279	42	9	3
Men ...	5,465	6	323	5,136	1,336	959	1,859	23	124	104	4,955	239	22	7	2
Women ...	897	—	40	857	140	66	119	7	12	6	842	21	19	2	1
Juveniles ...	1,260	—	66	1,194	462	291	176	—	5	26	1,082	17	1	—	—
{ Boys ...	1,260	—	66	1,194	462	291	176	—	5	26	1,082	17	1	—	—
{ Girls ...	26	—	—	26	4	2	2	—	—	1	26	2	—	—	—
	7,648	6	429	7,213	1,942	1,318	2,156	30	141	137	6,905	279	42	9	3

## Corradino Prison.

*Questions.**Answers.*

I. If the Prison is on a separate system, is the separation complete? And if not, what is the separation enforced by day and night respectively?

This prison is on the mixed cellular system as regards the criminal wards. The separation is complete as regards two of the five Sections under which the prisoners are classed, viz., A and B. In Section C association is allowed for 3 hours daily in the yards, but with *strict silence*, separation being enforced during the remaining hours. In section D conversation for one hour per day is also allowed with another prisoner designated by the Superintendent. In Section E association and conversation are allowed during the day. By night the separation is complete for all prisoners.

II. If not on the separate system, what provision is there for the supervision of the prisoners while in association?

The prisoners, while in association, are supervised by two or more Warders according to the number composing the section.

III. How many cells are there; and how many associated wards?

There are 212 separate cells, and three associated Wards.

IV. Taking the *average* number of prisoners in goal, how many cubic feet of space are there for each prisoner during the hours of sleep?

In the Criminal wards there are 1,120 cubic feet of space for each prisoner in 72 cells, and 1,260 cubic feet in the other 140 cells.

V. How are the prisoners classified?

In five Sections, from A to E inclusive, six months good conduct being required before passing from one system to another of less severity.

## Corradino Prison.

## Questions.

## Answers.

VI. Is penal labour—that is labour by treadmill, crank or shot drill—in force?

No.

VII. If so during what periods of imprisonment in respect of what classes of prisoners and during how many hours, is such penal labour enforced? In stating hours of tread wheel labour, give, first, the total time on and off at the wheel, &c., secondly, the length of spells and interval of rest.

See Answer No. VI.

VIII. What kind of labour, other than penal labour is in use?

Building, Stone-cutting, Carpentering, Glazing, Painting, Staining, Whitewashing, Tailoring, Mat and Broom-making, Gardening and Field labour.

IX. If the prisoners are employed beyond the wall of the goal, state:

1. On what kind of work they are so employed?
2. How are they supervised?
3. How many escapes of prisoners, while being employed beyond the goal, have taken place during each of the last three years?
4. How the profits of their labour are accounted for?

The prisoners are not employed outside the goal as a rule; but when stone and field labour is required, well conducted men are employed, supervised by one or more Warders.

None.

Lodged in the Colonial Treasury.

X. What was the total annual cost of the prison during the year 1892?

£ 3,706 17 6.

<i>Personal Emoluments</i>	...	...	...	£ 1,588 18 7
<i>Other Charges.</i>				
Uniforms	...	...	...	90 7 9
Bookbinding	...	...	...	6 13 7
Stationery	...	...	...	12 4 8
Provisions	...	...	...	1,515 18 11
Bedding	...	...	...	289 1 7
Gratuities	...	...	...	82 8 1
Materials for work	...	...	...	70 2 5
Drugs...	...	...	...	6 15 4
Transport	...	...	...	25 5 10
Water supply	...	...	...	18 18 9
				<u>£ 3,706 17 6</u>



RETURN of the GAOLS, &c.—*continued.*

## Corradino Prison.

## Questions.

## Answers.

XI. What was the annual amount of the prisoners' earnings during 1892?

£ 760 0 0. viz :		
Brooms and Matting	...	£ 110 0 0
Tailoring	...	60 0 0
Joiner's Work	...	80 0 0
Mason's "	...	60 0 0
Painter's "	...	60 0 0
Plasterer's "	...	60 0 0
Shoemaker's "	...	30 0 0
Stainer's "	...	30 0 0
Tinman's "	...	30 0 0
Plumber's "	...	30 0 0
Reclaiming waste land	...	110 0 0
Produce of Prison lands	...	100 0 0
		£ 760 0 0

XII. What are the number of the hours allotted for sleep? And, if sleep is in association, are the dormitories lighted; and how often are they patrolled during the night?

According to the Section. From one hour after sunset to day light. Light is allowed after sunset from 20 minutes to one hour according to the Section of the prisoners. All the wards are patrolled every half hour during the night.

XIII. What were the number and nature of the punishments inflicted for offences committed by prisoners undergoing imprisonment?

The number of punishments inflicted were 347. viz :	
Solitary confinement on bread and water	246
Dark Cell on bread and water	24
Deprived of Good Conduct stripes	3
Reduced to lower class	4
Admonished	70
	347

XIV. Is there, or are there, any Chaplain or Chaplains of any, and what religious persuasion?

One resident Roman Catholic Chaplain; and three visiting Chaplains, one Church of England, one Presbyterian, and one Wesleyan.

XV. Are religious services regularly, or otherwise, performed for the benefit of the prisoners of any, and if any, what religious persuasion?

There are two Chapels, viz. Catholic and Protestant, in which Divine Service is regularly performed by the Chaplains of above persuasions.

XVI. Are Roman Catholic Priests and dissenting Ministers allowed free access to prisoners of their own persuasion? and are they apprized when prisoners of their respective persuasion enter the prison?

Yes.

XVII. What provision is made for the education of prisoners?

The resident Chaplain is also Schoolmaster, and the prisoners are taught by him in their Cells as regards religious instruction; also reading and writing &c. if they wish it. The visiting Protestant Chaplain is assisted in his work by a Scripture-reader.

## Corradino Prison.

*Questions.*

XVIII. On what conditions are remissions of imprisonment granted?

XIX. Have Coroners's Inquests been held on every occasion of a death in prison during the past year and what were the verdicts?

XX.

(1.) What was the sanitary state of the Prison during the year 1892?

(2.) What were the prevailing diseases?

XXI. What are, shortly, the rules as to Diet?

*Answers.*

Every prisoner sentenced to imprisonment for twenty-five months and over, is entitled, if of good behaviour, to a remission of part of the remainder of his sentence, at the rate of one day for each week during the third year, and three days for each week during the subsequent years.

Two deaths occurred in 1892; one from heart disease and one from congestion of the brain. An Inquest was held in the latter case.

Excellent.

Syphilis, Heart-disease, and Gastric disorders.

*Simple Imprisonment.*

First three Weeks—

Sundays, Tuesdays and Thursdays, 24 oz. bread and  $\frac{1}{2}$  pint soup.

Mondays, Wednesdays, Fridays, and Saturdays 27 oz. bread and 1 ration cheese, salt-fish or olives.

Remaining time—

28 oz. bread, 1 pint soup on Sundays, Tuesdays and Thursdays.

31 oz. bread, and 1 ration cheese, olives or salt-fish on the other four days.

The rations of cheese, olives or salt-fish consist of 1  $\frac{1}{2}$ , 2  $\frac{1}{2}$  and 2 oz. respectively.

*Hard Labour.*

An addition of one pint coffee, nine oz. bread or [ $\frac{1}{2}$  pint soup] and  $\frac{1}{2}$  ration of cheese, olives or salt fish; and on Sunday also four oz. meat.

The soup is made of paste and vegetables, with lard or oil. Prisoners with "Good Conduct Stripes" have also an allowance of wine per diem, and fruit and extra meat on Sundays according to the number of Stripes.

Valletta Prison. (*In the Palace of the Courts of Justice.*)*Questions.**Answers.*

I. If the Prison is on a separate system, is the separation complete? And if not, what is the separation enforced by day and night respectively?

It is not in a separate system, and no effectual separation can, as a rule, be enforced either by night or by day in consequence of the premises being so defective and ill suited for the object for which they are intended, viz :

- 1st. The detention of persons sentenced to imprisonment for periods not exceeding three days ;
- 2nd. The temporary detention of persons apprehended, until taken before the Magistrates ;
- 3rd. The detention of offenders undergoing examination by the Magistrates ;
- 4th. The detention of offenders committed for trial before H. M.'s Criminal Court.

II. If not on the separate system, what provision is there for the supervision of the prisoners while in association?

They are occasionally supervised by the Keeper of the Prison and by his Assistant.

III. How many cells are there ; and how many associated wards ?

There are 16 cells, only 12 of which can be used, the remaining four being very damp, dark and unsanitary.

IV. Taking the *average* number of prisoners in goal, how many cubic feet of space are there for each prisoner during the hours of sleep ?

Considering that in the front wall of each cell there is a large opening looking into the adjoining yard, and the consequent continued admittance of pure air, besides the ventilators leading to the roof of the prison, no possible doubt can be entertained of the prisoners breathing foul air, or being in any way too closely confined.

V. How are the prisoners classified ?

Endeavours are made to classify them as per Answer to Question I, but very often this is found to be impracticable. On many occasions the separation of boys from grown up criminals and even of the latter from female prisoners is as much as can be effected.

VI. Is penal labour—that is labour by tread-mill, crank, or shot drill—in force ?

No hard labour in force.

## Valletta Prison.

*Questions.**Answers.*

- VII. If so during what periods of imprisonment in respect of what classes of prisoners and during how many hours, is such penal labour enforced? In stating hours of tread wheel labour, give, first, the total time on and off at the wheel, &c., secondly, the length of spells and intervals of rest.
- VIII. What kind of labour, other than penal labour is in use?
- IX. If the prisoners are employed beyond the wall of the goal, state:
1. On what kind of work they are so employed?
  2. How are they supervised?
  3. How many escapes of prisoners, while being employed beyond the goal, have taken place during each of the last three years?
  4. How the profits of their labour are accounted for?
- X. What was the total annual cost of the prison during the year 1892?

See Answer No. VI.

None.

See Answer No. VI.

The total annual cost in 1892 was

Salary to Keeper ... ..	£	50	0	0
Provisions ... ..		245	10	8
Bedding, Furniture, &c. ... ..		62	15	0
	£	358	5	8



## Valletta Prison.

*Questions.**Answers.*

- XI. What was the annual amount of the prisoners' earnings during 1892? *See Answer No. VI.*
- XII. What is the number of hours allotted for sleep? And, if sleep is in association are the dormitories lighted; and how often are they patrolled during the night? *There is no limited time for sleep.  
There are no dormitories, but cells only which are visited by the Prison Keeper or his Assistant occasionally during the night.*
- XIII. What were the number and nature of the punishments inflicted for offences committed by prisoners undergoing imprisonment? *None.*
- XIV. Is there, or are there, any Chaplain or Chaplains of any, and what religious persuasion? *There is a Roman Catholic Priest who performs Divine Service on Sundays and other holidays.*
- XV. Are religious services regularly, or otherwise, performed for the benefit of the prisoners of any, and if any, what religious persuasion? *Regularly for Catholics only.*
- XVI. Are Roman Catholic Priests and Dissenting Ministers allowed free access to prisoners of their own persuasion? and are they apprized when prisoners of their respective persuasion enter the prison? *Clergymen of every religious persuasion have free access to the prisoners, when the latter require their assistance.*
- XVII. What provision is made for the education of Prisoners? *None.*
- XVIII. On what conditions are remissions of imprisonment granted? *Remissions of imprisonment are granted, or withheld, by His Excellency the Governor after enquiries into the circumstances connected with each case.*

## Valletta Prison.

*Questions.**Answers.*

XIX. Have Coroner's Inquests been held on every occasion of a death in prison during the past year and what were the verdicts?

No death occurred in 1892.

XX.

(1). What was the sanitary state of the Prison during the year 1892?

Fair.

(2). What were the prevailing diseases?

None.

XXI. What are, shortly, the rules as to Diet?

Detention prisoners who have no means and all others who are undergoing punishment are fed at the public expense by rations supplied from the Ospizio on requisition by the Superintendent of Police. A day's ration consists of

26 oz. Bread;

4 oz. *Pasta* made into soup with oil and vegetables; and

2½ oz. of Cheese,

or

2½ oz. of Salt Fish,

$\frac{1}{10}$  of *Mondello* Olives.

GAOL FOR UNTRIED PRISONERS.  
COURTS OF JUSTICE.  
VALLETTA.

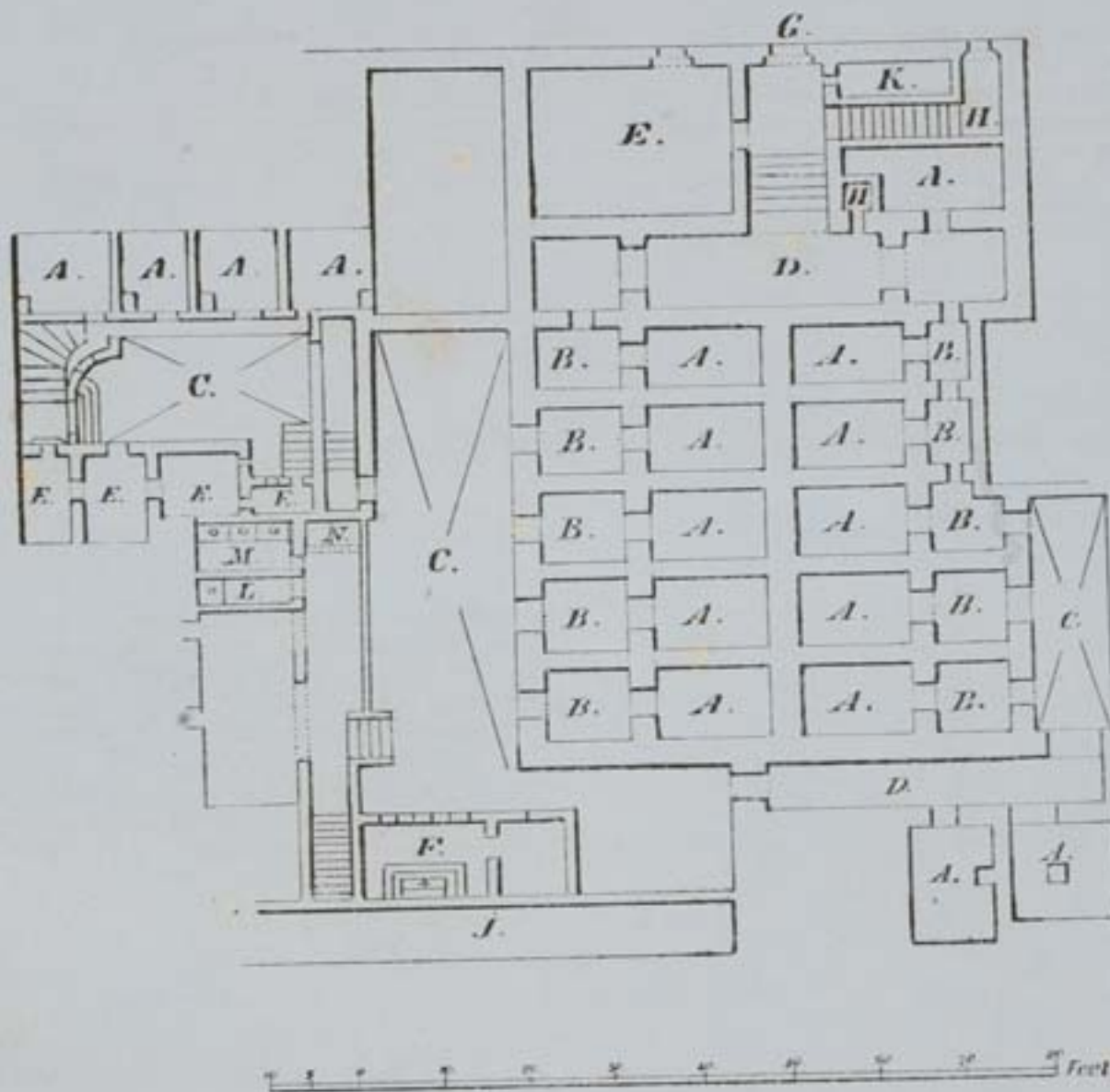

- |                                  |  |
|----------------------------------|--|
| A. Cells.                        | H. Staircases leading to Court above.            |
| B. Exercising Entrances.         | J. Corridor leading to Courts and Police Office. |
| C. Large Yards.                  | K. Lumber Room.                                  |
| D. Corridors.                    | L. W. C. for Police Officers.                    |
| E. Gaolers' Apartments.          | M. Latrine.                                      |
| F. Chapel.                       | N. Urinals.                                      |
| G. Entrance from Strada Stretta. |  |

OFFICE OF THE ATTORNEY GENERAL

STATE OF NEW YORK

ALBANY

No.	Name	Amount	Date	Total
1	John Smith	\$100.00	1/1/19	\$100.00
2	Jane Doe	\$200.00	2/1/19	\$300.00
3	John Smith	\$150.00	3/1/19	\$450.00
4	Jane Doe	\$250.00	4/1/19	\$700.00
5	John Smith	\$300.00	5/1/19	\$1,000.00
6	Jane Doe	\$350.00	6/1/19	\$1,350.00
7	John Smith	\$400.00	7/1/19	\$1,750.00
8	Jane Doe	\$450.00	8/1/19	\$2,200.00
9	John Smith	\$500.00	9/1/19	\$2,700.00
10	Jane Doe	\$550.00	10/1/19	\$3,250.00
11	John Smith	\$600.00	11/1/19	\$3,850.00
12	Jane Doe	\$650.00	12/1/19	\$4,500.00



## RETURN of the GAOLS, &amp;c.—Continued.

**PRISON for Women** (*attached to the Ospizio at Floriana*).*Questions.**Answers.*

I. If the Prison is on a separate system, is the separation complete? And if not, what is the separation enforced by day and night respectively?

This prison is not on the separate system. The prisoners are divided according to the nature of their sentence, viz. hard labour, imprisonment, and detention, there being two rooms for each of the 1st and 3rd classes, and one for the 2nd.

II. If not on the separate system, what provision is there for the supervision of the prisoners while in association?

A sister of Charity is constantly in the prison to supervise the prisoners' conduct.

III. How many cells are there; and how many associated wards?

See Answer to question No. 1.

IV. Taking the *average* number of prisoners in gaol, how many cubic feet of space are there for each prisoner during the hours of sleep?

There are 952 cubic feet of space for each prisoner in the detention room, 960 in the imprisonment room, and 1010 in the hard labour room.

V. How are the prisoners classified?

Into three categories, viz. those condemned to detention, those condemned to imprisonment, and those condemned to hard labour.

VI. Is penal labour — that is labour by treadmill, crank, or shot drill—in force?

No.

VII. If so during what periods of imprisonment in respect of what classes of prisoners and during how many hours, is such penal labour enforced? In stating hours, of tread wheel labour, give, first, the total time on and off at the wheel, &c., secondly, the length of spells and intervals of rest.

See Answer No. VI.

## Prison for Women.

*Questions.*

VIII. What kind of labour, other than penal labour, is in use?

*Answers.*  
The prisoners who enjoy good health are employed in the wash-house of the Asylum for the aged and infirm which is contiguous to the prison; they are made to sew and patch clothing and bedding of the several Institutions.

IX. If the prisoners are employed beyond the wall of the gaol, state:

1. On what kind of work they are so employed?

*See preceding reply.*

2. How are they supervised?

A sister of Charity, who is the Matron, is constantly superintending their work.

3. How many escapes of prisoners, while being employed beyond the gaol, have taken place during each of the last three years?

None. *See reply to question No. VIII.*

4. How are the profits of their labour accounted for?

*See Answer to question No. XI.*

X. What was the total annual cost of the prison during the year 1892?

£ 180 8 7.

Salary to Matron	...	...	...	...	...	£ 21 13 4
Provisions	...	...	...	...	...	145 2 9
Bedding &c.	...	...	...	...	...	13 12 6
						£ 180 8 7

XI. What was the annual amount of the prisoners' earnings during 1892?

None; prisoners are only allowed a ration of wine ( $\frac{1}{4}$  of a pint), in remuneration for their work, when their conduct is good.

## Prison for Women.

*Questions.*

- XII. What is the number of hours allotted for sleep? And, if sleep is in association are the dormitories lighted; and how often are they patrolled during the night?
- XIII. What were the number and nature of the punishments inflicted for offences committed by prisoners undergoing imprisonment?
- XIV. Is there, or are there, any Chaplain or Chaplains of any, and what religious persuasion?
- XV. Are religious services regularly, or otherwise, performed for the benefit of the prisoners of any, and if any, what religious persuasion?
- XVI. Are Roman Catholic Priests and Dissenting Ministers allowed free access to prisoners of their own persuasion? and are they apprized when prisoners of their respective persuasion enter the prison?
- XVII. What provision is made for the education of prisoners?
- XVIII. On what conditions are remissions of imprisonment granted?

*Answers.*

- From eight to nine hours. They sleep in association, with lighted dormitories, and are generally patrolled once, but oftener when the number and general conduct of the prisoners render it advisable.
- There were 42 cases of punishments during the year on 20 Prisoners, who refused to work or were otherwise insubordinate. The punishment consisted
- In 4 cases, in solitary confinement for 2 days, except 2 hours allowed daily for exercise, on 4 Prisoners.
- In 29 cases it consisted in stoppage of wine or dessert for periods varying from 2 to 7 days, on 7 prisoners.
- In 8 cases it consisted in one hour extra work for one week, besides stoppage of wine or dessert as above, on 8 prisoners.
- In 1 case the prisoner was deprived of the visit of her relatives for once, besides being deprived of wine and dessert, as above.
- There are two Roman Catholic Chaplains attached to the Asylum for the aged and infirm and they perform duties likewise in the prison. Clergymen of other persuasions visit the prison when required.
- Religious services of the Roman Catholic Church are regularly performed for the benefit of the prisoners, who are all, generally, of that persuasion.
- Since the transfer of the Ospizio one Roman Catholic Priest attends daily and performs Divine Service in the Prison, and other ministers are allowed free access at their request or at that of the prisoners.
- Only Catholic Religious Instruction is imparted to the prisoners through Sermons and the Catechism or Christian Doctrine.
- Remissions of imprisonment are granted, or withheld, by His Excellency the Governor.

## Prison for Women.

*Questions.**Answers.*

XIX. Have Coroner's Inquests been held on every occasion of a death in prison during the past year and what were the verdicts?

There is no such authority in Malta. The Magistrates of Judicial Police hold an inquest in cases of "Violent deaths," or deaths the cause of which is unknown. No such case occurred in 1892.

XX.

(1). What was the sanitary state of the Prison during the year 1892?

The prison rooms are rather damp, and a wooden pavement has consequently been laid, but their sanitary state is good in other respects.

(2). What were the prevailing diseases?

Influenza.

XXI. What are, shortly, the rules as to Diet?

Every prisoner is allowed: bread, 2nd quality, 20 oz., beef 3 oz., potherbs 1 ration, fruit 1 ration, pasta  $3\frac{1}{4}$  oz., of rice  $3\frac{3}{4}$  oz., coffee  $\frac{3}{4}$  oz., sugar  $\frac{1}{2}$  oz.



## Gozo Prison.

*Questions.**Answers.*

I. If the Prison is on a separate system, is the separation complete? And if not, what is the separation enforced by day and night respectively?

It is not on a separate system, but as the number of prisoners is comparatively small, the premises admit of the separation of persons sentenced to imprisonment from others who are under examination or remitted for trial.

II. If not on the separate system, what provision is there for the supervision of the prisoners while in association?

They are occasionally supervised by the Keeper of the prison.

III. How many cells are there; and how many associated wards?

There are four cells and three wards, two of which wards with airing-yards attached.

IV. Taking the *average* number of prisoners in goal, how many cubic feet of space are there for each prisoner during the hours of sleep?

Both the cells and the wards being very spacious and considering the limited number of persons detained in the same, no possible doubt can be entertained of the prisoners being too closely confined.

V. How are the prisoners classified?

See Answer to question No. 1.

VI. Is penal labour—that is labour by treadmill, crank or shot drill—in force?

No penal labour in force.

VII. If so during what periods of imprisonment in respect of what classes of prisoners and during how many hours, is such penal labour enforced? In stating hours of tread wheel labour, give, first, the total time on and off at the wheel, &c., secondly, the length of spells and intervals of rest.

See Answer to question No. VI.

## Gozo Prison.

*Questions.*

VIII. What kind of labour, other than penal labour is in use?

IX. If the prisoners are employed beyond the wall of the goal, state:

1. On what kind of work they are so employed?
2. How are they supervised?
3. How many escapes of prisoners, while being employed beyond the goal, have taken place during each of the last three years?
4. How are the profits of their labour accounted for?

X. What was the total annual cost of the prison during the year 1892?

XI. What was the annual amount of the prisoners' earnings during 1892?

XII. What is the number of hours allotted for sleep? And, if sleep is in association, are the dormitories lighted; and how often are they patrolled during the night?

*Answers.*

Sweeping and cleansing the prison and conveying water to the same.

The prisoners are not employed beyond the walls of the Gaol.

The total annual cost in 1892 was

Salary to Keeper ... ..	£ 30 0 0
Ecclesiastical ... ..	7 17 8
Provisions ... ..	27 1 5
Bedding ... ..	2 0 3
	<hr/>
	£ 66 19 1

See Answer to question No. VI.

There is no limited time for sleep.

## Gozo Prison.

*Questions.**Answers.*

XIII. What were the number and nature of the punishments inflicted for offences committed by prisoners undergoing imprisonment?

No punishment was inflicted for offences committed in the prison.

XIV. Is there, or are there, any Chaplain or Chaplains of any, and what religious persuasion?

There is no Chaplain attached; but mass is celebrated on Sundays and other Holidays by a Roman Catholic Clergyman paid by Government.

XV. Are religious services regularly, or otherwise, performed for the benefit of the prisoners of any, and if any, what religious persuasion?

*See Answer to question No. XIV.*

XVI. Are Roman Catholic Priests and dissenting Ministers allowed free access to prisoners of their own persuasion? and are they apprized when prisoners of their respective persuasion enter the prison?

Clergymen of every denomination are permitted to visit the prisoners who wish to see them.

XVII. What provision is made for the education of prisoners?

*See Answer to question No. I. as to the nature of the prison.*

XVIII. On what conditions are remissions of imprisonment granted?

Remissions of imprisonment are granted, or withheld, by His Excellency the Governor, after inquiries into the circumstances connected with each case.

XIX. Have Coroners's Inquests been held on every occasion of a death in prison during the past year and what were the verdicts?

No death occurred in 1892.

## Gozo Prison.

*Questions.**Answers.*

XX.

(1.) What was the sanitary state of the Prison during the year 1892?

Good.

(2.) What were the prevailing diseases?

None.

XXI. What are, shortly, the rules as to Diet?

The prisoners are maintained at the public expense; their daily allowance of food consists of 26 oz. of bread, 4 oz. of pasta,  $2\frac{1}{2}$  oz. of cheese, or salt-fish, or  $\frac{1}{2}$  lb. of *mondello* olives.



**GOZO.**

**PRISON AT THE CASTLE  
RABATO GOZO**

*for persons sentenced to take their trial.*

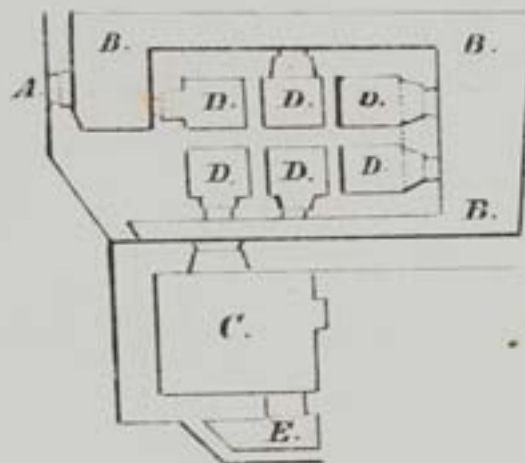

- A. Entrance.*
- B. Court-yard.*
- C. Room.*
- D. Small cells.*
- E. Cortile.*

1

2022

REPORT OF THE BOARD  
OF DIRECTORS

FOR THE YEAR ENDED 31st DECEMBER 2022



Page 1 of 1