

Y

GOVERNMENT HOUSES.

1901.

HOUSES OCCUPIED AS

| Name and situation | Number and size of | | | What is the heating and lighting arrangement and at whose cost? | Amount and description of | |
|------------------------|---|---|--|--|---------------------------|--------|
| | Reception Rooms | Family Bedrooms | Servants' Bedrooms | | Land | Garden |
| Valletta Palace | Billiard Room 35'-4" X 33'-1" | Spare Room 27'-4" X 17'-8" | One Room 18'-6" X 13'-5" | Heating by coals which are supplied at the Governor's expense. Lighting by Electricity at the average cost of £ 151 14 0 a year, of which £ 121 14 0 is paid by Government and £ 30 by the Governor. | Nil. | Nil. |
| | State Drawing Room 35'-10" X 55'-2" | Spare Room 28' X 19' | One Room 18' X 13'-6" | | | |
| | Ball Room 82'-2" X 37'-3" | Spare Room 23'-7" X 19'-2" | A.D.C.'s Room Servants' Room 19'-10" X 9'-7" | | | |
| | Dining Room 66'-10" X 21'-6" | His Excellency's Room 24'-2" X 21'-5" | One Room 21'-2" X 14'-3" | | | |
| | Day Room 17'-3" X 16'-10" | His Excellency's Room 25' X 20'-4" | One Room 20'-6" X 14'-2" | | | |
| | Day Room 17'-0" X 16'-4" | His Excellency's Room 24'-10" X 20'-8" | One Room 23'-9" X 14'-3" | | | |
| | Private Drawing Room 45'-4" X 20'-9" | Spare Room 24' X 19'-3" | Steward's Quarters | | | |
| | | Spare room 24' X 19'-10" | Chief Messenger's Quarters | | | |
| | | Spare Room 24' X 19'-6" | Fatiguan's Quarters | | | |
| | | A.D.C.'s Room 27'-11" X 18'-11" | Coachman's Quarters | | | |
| | | A.D.C.'s Room 29'-4" X 17'-9" | | | | |
| | | A.D.C.'s Room 32'-11" X 12'-2" | | | | |
| | | A.D.C.'s Room 26' X 15'-9" | | | | |

RESIDENCES BY THE GOVERNOR.

| Number of Labourers and Gardeners required | Any expenses necessarily borne by Governor in 1901 | Furniture | | | | Other information useful for a new Governor |
|---|--|------------------------------------|---|---|---------------------------------|---|
| | | If supplied by Colonial Government | Percentage annually payable | Is Plate, Linen, Crockery, Glass supplied by Colonial Government? | Percentage payable | |
| The only Gardener employed for cultivating the Palace and Yards is paid by the Colonial Government. | Nil. | Yes | 5 ⁰ / ₁₀₀ on certain amount | Plate, table-linen, crockery, glass and kitchen utensils are supplied by the Colonial Government. | 5 ⁰ / ₁₀₀ | Besides this Palace, the Governor enjoys also the use of other two Palaces (St. Antonio and Verdala) which may be considered as summer Resorts. |

| Name and situation | Number and size of | | | What is the heating and lighting arrangement and at whose cost? | Amount and description of | |
|---|---------------------------------|--|--|---|---|--|
| | Reception rooms | Family Bedrooms | Servants' Bedrooms | | Land | Garden |
| St. Antonio Palace and Gardens within the limits of Casal Attard. | Drawing Room 35'-6" x 27'-9" | His Excellency's Room 22'-7" x 21'-8" | Upper floor One Room 21'-1" x 19' | Heating is obtained by means of Iron coal Stoves, and Lighting by Petroleum Lamps and Candles all at the expense of the Governor. | Kitchen-garden on the other side of the road, of the extent of Acres, 2. 0. 35. | Public Gardens of the extent of 15 acres. Private Gardens of 44 acres. |
| | Dining Room 39'-5" x 26'-6" | His Excellency's Room 21' x 17'-4" | One Room 15'-4" x 11'-1" | | | |
| | Day Room 34'-4" x 24'-4" | A.D.C.'s Room 24'-6" x 22'-5" | One Room 15'-2" x 11' | | | |
| | | A.D.C.'s Room 25'-6" x 24'-1" | One Room 19'-2" x 15'-11" | | | |
| | | A.D.C.'s Room 30'-1" x 14' x 1" | One Room 19' x 10'-4" | | | |
| | | Spare Room 30' x 14'-3" | One Room 18'-10" x 16'-1" | | | |
| | | Spare Room 21'-5" x 14'-3" | One Room 10'-6" x 9'-2" | | | |
| | | Spare Room 19' x 17'-10" | One Room 18'-8" x 15'-10" | | | |
| | | Spare Room 20'-5" x 18' | One Room 10'-5" x 9'-3" | | | |
| | | Spare Room 22' x 19'-2" | One Room 13'-5" x 10' | | | |
| | | Spare Room 21'-11" x 18'-3" | One Room 17' x 14'-1" | | | |
| | | Spare Room 30'-10" x 24'-4" | Fatiguelman's Quarters | | | |
| | | Spare Room 24'-2" x 21'-11" | Ground floor Spare Room 21'-10" x 18'-3" | | | |
| | | | Caretaker's Quarters | | | |
| | | Gardeners' Quarters | | | | |

RESIDENCES BY THE GOVERNOR.

| Number of Gardeners and Labourers required | Any expenses necessarily borne by Governor in 1900 | Furniture | | | | Other information useful for a new Governor |
|---|--|------------------------------------|------------------------------------|---|--------------------|--|
| | | If supplied by Colonial Government | Percentage annually payable | Is Plate, Linen Crockery, Glass supplied by Colonial Government ? | Percentage payable | |
| <p>IN PUBLIC GARDENS.</p> <p>Four Gardeners and Labourers and one Policeman, besides occasional extra Labourers, paid out of the Colonial Funds.</p> <p>IN PRIVATE GARDENS.</p> <p>Five Gardeners and Labourers paid out of the Colonial Funds.</p> | Nil. | Yes | $5\frac{1}{2}\%$ on certain amount | | $5\frac{1}{2}\%$ | Independently of a kitchen-garden, used as such when required, its expenses being defrayed by the Governor, there exists at this Palace a Cow-house, where a Cow-man is employed, paid also by the Governor. |
| | | | | Plate, table-linen, crockery and glass are supplied by the Colonial Government. | | |

HOUSES OCCUPIED AS

| Name and situation | Number and size of | | | What is the heating and lighting arrangement and at whose cost? | Amount and description of | |
|---|--------------------------|--------------------------|---------------------------|---|---------------------------|---|
| | Reception rooms | Family Bedrooms | Servants' Bedrooms | | Land | Garden |
| Verdala Palace situate at $1\frac{1}{2}$ miles to the south, and within the limits of Notabile. | Five | Nine | Twelve | None. It has to be provided at the Governor's expense. | Nil. | 15 Acres planted for the most part with wild trees. |
| | $29' \times 17'$ | $21'-7'' \times 20'$ | $20'-10'' \times 24'-5''$ | | | |
| | $21'-3'' \times 20'$ | $21'-9'' \times 20'$ | $9'-6'' \times 9'-6''$ | | | |
| | $29' \times 45'-3''$ | $21'-3'' \times 20'$ | $20'-4'' \times 19'$ | | | |
| | $28'-3'' \times 19'-8''$ | $21'-9'' \times 20'$ | $21' \times 8'-8''$ | | | |
| | $29' \times 48'$ | $27' \times 22'-9''$ | $21'-9'' \times 17'-4''$ | | | |
| | | $24'-8'' \times 21'-7''$ | $20'-10'' \times 7'-4''$ | | | |
| | | $24'-8'' \times 21'-6''$ | $21'-8'' \times 14'-10''$ | | | |
| | | $24'-6'' \times 20'-5''$ | $17'-7'' \times 16'-9''$ | | | |
| | | $24'-4'' \times 22'-5''$ | $20'-10'' \times 15'-3''$ | | | |
| | | | $21' \times 15'-2''$ | | | |
| | | | $21' \times 15'$ | | | |
| | | | $21' \times 15'-2''$ | | | |

RESIDENCES BY THE GOVERNOR.

| Number of Labourers and Gardeners required | Any expenses necessarily borne by Governor in 1900 | Furniture | | | | Other information useful for a new Governor |
|--|--|------------------------------------|-----------------------------|---|--------------------|---|
| | | If supplied by Colonial Government | Percentage annually payable | Is Plate, Linen, Crockery, Glass supplied by Colonial Government? | Percentage payable | |
| Two men besides occasional Extra Labour. | Nil. | Yes | 5% on certain amount | Plate, table-linen, crockery, glass and kitchen utensils are supplied by the Colonial Government. | 5% | |

GOVERNOR'S PALACE — VALLETTA



GROUND FLOOR



- | | |
|--|--|
| <ul style="list-style-type: none"> a. Coachman's Quarters. b. Harness Room. c. Stables and Coal House. d. Staircase to Armoury. e. Chief Staff Officer's Office. f. Chief Secretary's Office. g. Crown Advocate's Office. | <ul style="list-style-type: none"> h. Executive Council Office. i. Council Office. j. Printing Office. k. R. M. Reg. Orderly and Anteroom l. Receiver General's Office. m. Public Works Office. n. Public Works Store Room. |
|--|--|



- | | | | |
|-----|---------------------------------------|-----|------------------------------------|
| 1. | Bed Room. | 18. | Hall. |
| 2. | Do. | 19. | Council Chamber. |
| 3. | Linen Rooms. | 20. | Cloak Room. |
| 4. | Bed Rooms. | 21. | Steward's Store Room. |
| 5. | Asst. Mil. Secretary's Office. | 22. | Servants' Store Rooms. |
| 6. | H. Excellency's Office. | 23. | |
| 7. | A. D. C's Office. | 24. | Bed Room. |
| 8. | Billiard Room. | 25. | Do. |
| 9. | State Drawing Room. | 26. | Do. |
| 10. | Ball Room. | 27. | Steward's Dining Room. |
| 11. | Dining Room. | 28. | Steward's Store Room. |
| 12. | Day-Rooms. | 29. | Pantry. |
| 13. | | 20. | Servants' Dining Room. |
| 14. | H. Excellency's Private Drawing Room. | K. | Kitchen, Larder Room and Scullery. |
| 15. | H. Excellency's Bed Rooms. | | |
| 16. | | | |
| 17. | | | |

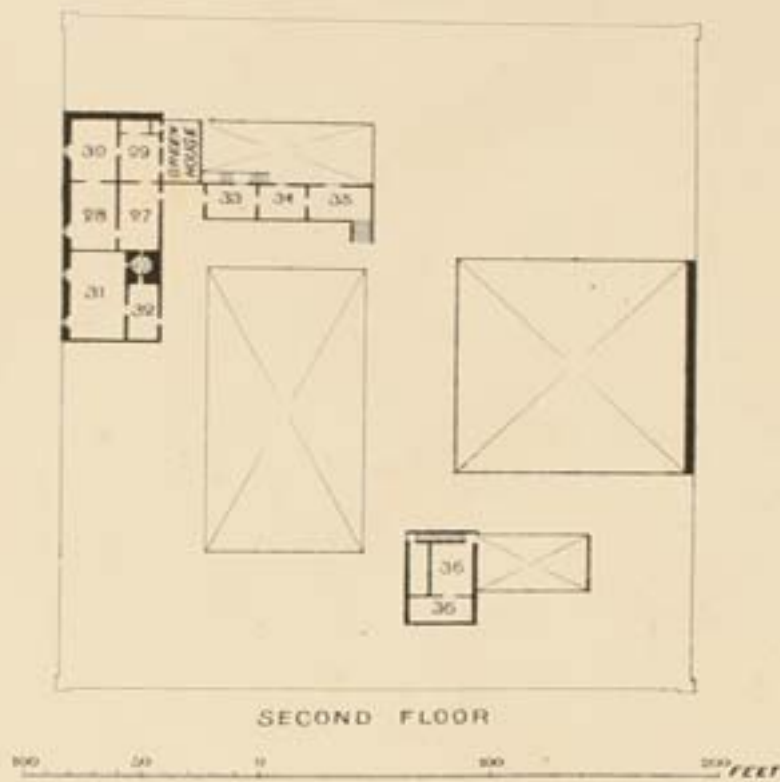

- 27. Room.
- 28. Bed Room.
- 29. Room.
- 30. Bed Room.
- 31. Bed Room.
- 32. {
- 33. { Servants' Bed Room.
- 34. {
- 35. }
- 36. Steward's Quarters.

Chief Messenger and Fatiguemen have accommodation on Terrace.

SANT'ANTONIO .. PALACE & GARDENS

GROUND FLOOR

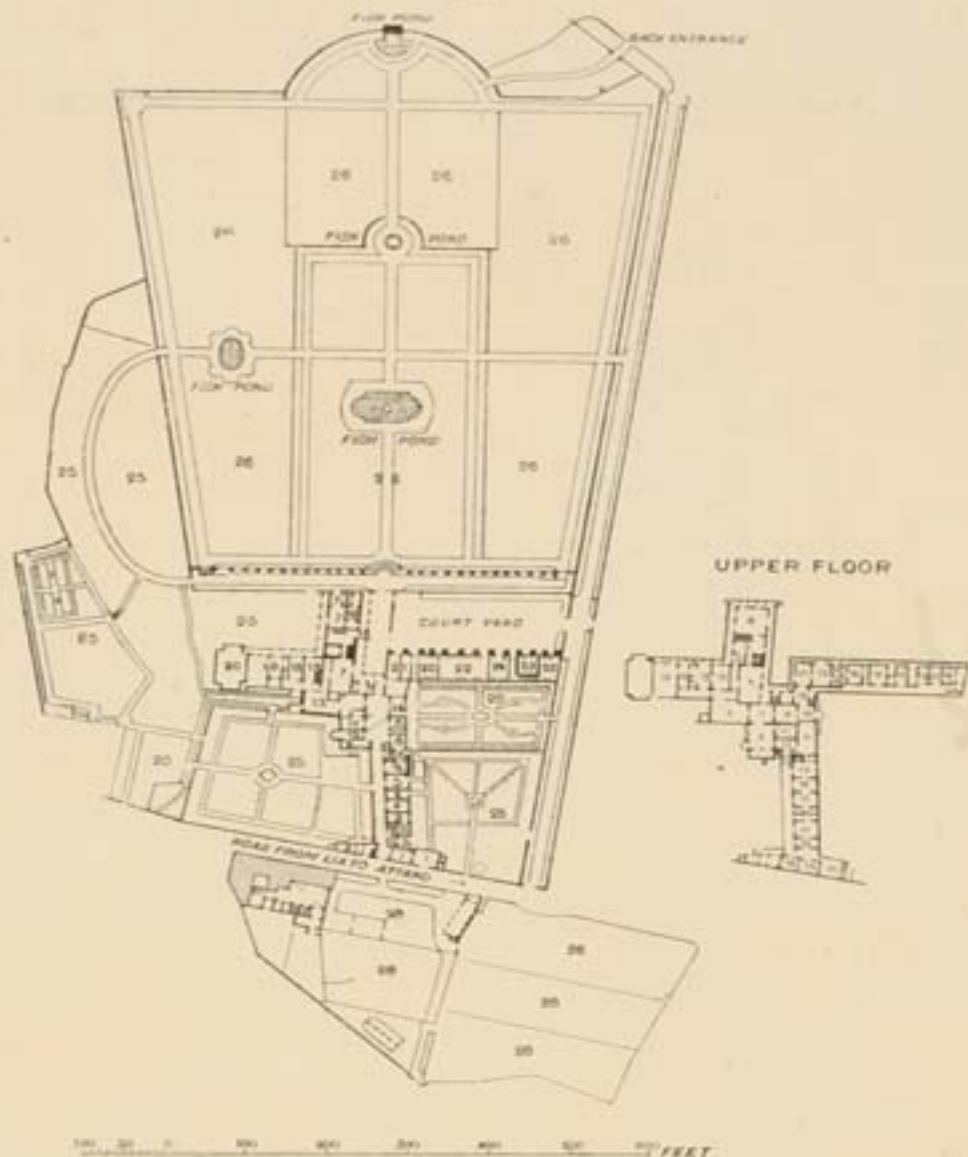

GROUND FLOOR.

1. Policeman's Quarters.
2. Keeper's Quarters (with upper floor).
3. Head gardener's Quarters.
4. Covered space attached to the Private Gardens.
5. Entrance to Private Gardens.
6. Tools' Store.
7. Spare Room.
8. Store Room.
9. Passage and Winding Staircase.
10. Chapel (Roman Catholic).
11. Dairy.
12. Closet.
13. Kitchen.
14. Room for deposit of Seeds.
15. Entrance to the Palace.
16. Telegraph Office.
17. Scullery.
18. Pantry.
19. Servants Room.
20. Chapel (Protestant).
21. Room for Harness and Groom.
22. Stables.
23. Coach House.
24. Room for deposit of vegetable Earth.
25. His Excellency's Private Gardens.
26. Public Gardens.
27. Cow-sheds.
28. Kitchen Gardens.

UPPER FLOOR.

1. Main Corridor.
2. Dining Room.
3. Closet.
4. Billiard Room.
5. Staircase and Lobby.
6. Drawing Room.
7. Octagonal Room.
8. Spare Room.
9. A. D. C.'s Office.
10. Access to the Private Garden.
11. Boudoir.
12. Passage.
13. His Excellency's Office.
14. His Excellency's Bed-room.
15. The lady's Boudoir.
16. Bath-room, Toilette and W. C.
17. The lady's Bed-room.
18. Spare Bed-rooms.
19. Pantry.
20. W. C.
21. Steward's Office.
22. Servants' Quarters.



VERDALA PALACE & GARDENS ATTACHED

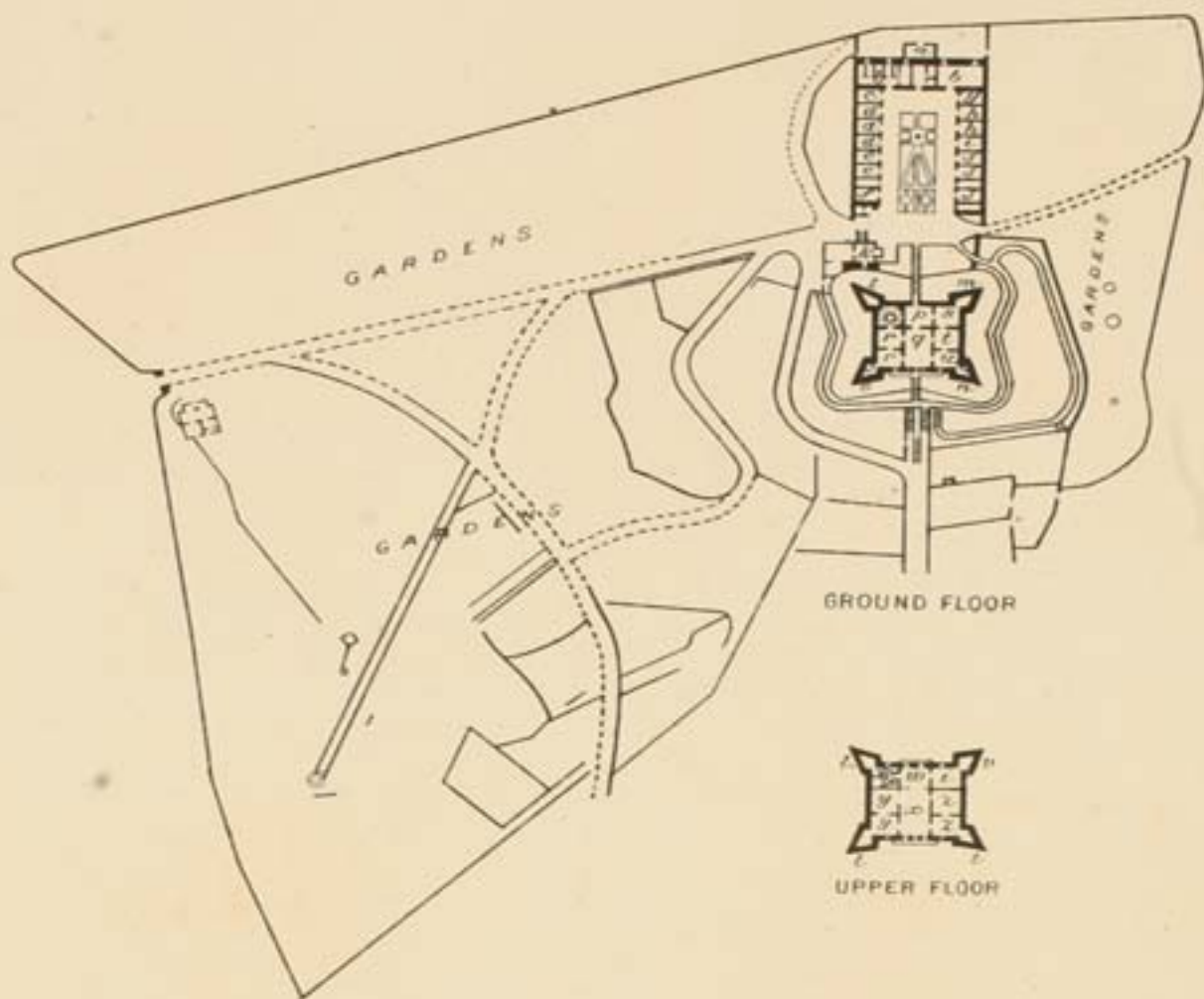

100 50 0 100 200 300 400 500 FEET

- | | |
|-------------------------------------|--|
| a. Forage Room. | o. W. C. (Larder under). |
| b. Stables. | p. Hall (entrance under). |
| c. Harness Room. | q. Drawing Room (room under). |
| d. Servants' Room. | r. Bed Rooms (kitchen and scullery under). |
| e. Store. | s. Dining Room (Servants' room under). |
| f. Keeper's Room. | t. Governor's Bed-room (room under). |
| g. Coach House. | u. Office (room under). |
| h. Cow shed. | v. Bath-Room. |
| i. Dairy. | w. Lobby. |
| j. Servants' Room. | x. Billiard-room. |
| k. Chapel. | y. A. D. C's Room. |
| l. W. C. | z. Visitors' Room. |
| m. Pantry (telegraph office under). | zi. Smoking Room. |
| n. W. C. (room under). | |

