

V

LUNATIC ASYLUM

1903-1904.

LUNATIC ASYLUM RETURN, for the year 1903-1904.

Question I. (Statistical).  
GENERAL STATISTICAL TABLE.

	Remaining on 1st March 1903	Number Admitted during above period	Daily Average Number during above period	Number of Attendants				Discharges				Number of Patients who died in above period	Average Stay of those			
				Resident		Non-Resident		Cured	Relieved	Not improved	Not objects for the Asylum		Died in above period	Discharged in above period	Remaining on 1st March 1904	Remaining on 1st March 1904
				Employed in Attendance on the Patients	Employed as servants or only partially as Attendants	Employed in Attendance on the Patients	Employed as servants or only partially as Attendants									
Male...	381	96	383	27	6	4	9	30	14	6	20	21	3663	284	4152	377
Female	281	60	280	25*	3†	1	4	19	9	7	6	24	3594	274	4155	276
Totals	662	156	663	52	9	5	13	49	23	13	35	45	—	—	—	653

\* Six are Sisters of Charity who perform duty only in the Female Division.

† One is a Sister of Charity in charge of the Wash-house.

OBITUARY TABLE.

Number of deceased on Register	Age of deceased	Sex of deceased	Body condition when admitted	Form of Mental Disorder	Date of Admission	Cause of Death	State whether a Coroner's Inquest was held and what was the Verdict	State whether a Post Mortem Examination was held
3236	62	M.	Good	Mania	20. 11. 89.	Debility		
4320	44	"	Do.	Persec: Mania	27. 11. 02.	Apoplexy		
4402	53	"	Sick	Observation	1. 10. 03.	Cerebral Congestion		
4344	71	"	Weak	Dementia	8. 11. 02.	Maniacal exhaus:		
3354	82	"	Good	Delus: insanity	2. 4. 91.	Enteritis		
3906	52	"	Do.	Mania	21. 1. 98.	Do.		
4034	81	"	Do.	Delus: mania	3. 7. 99.	Cerebral softening		
4359	30	"	Sick	Observation	10. 5. 03.	General paral:		
3431	62	"	Good	Delus: insanity	18. 2. 92.	Cardiopathia		
1763	77	"	Do.	Mania	24. 1. 66.	Apoplexy		
2750	55	"	Do.	Lypemania	25. 4. 83.	Enteritis		
4375	40	"	Do.	Do.	14. 7. 03.	Cerebral softening		
3607	46	"	Do.	Alcoholiam	12. 3. 94.	Enteritis		
4412	26	"	Sick	Amentia	18. 11. 03.	General debility		
4425	40	"	Do.	Epileptic delirium	29. 12. 01.	Cerebral syphilis		
4328	81	"	Good	Dementia Senilis	3. 1. 03.	Cerebral Congestion		
4451	54	"	Sick	Hypochondria	4. 2. 04.	General debility		
4372	68	"	Good	Lypemania	3. 7. 03.	Do.		
1939	64	"	Do.	Do.	5. 12. 69.	Cardiopathia		
4408	52	"	Do.	Confus: insanity.	9. 11. 03.	General paral:	Nil.	Nil.
4434	35	"	Sick	Unclassified	26. 2. 04.	Maniacal Exhaustion		
2812	78	F.	Good	Delus: mania	29. 10. 94.	Cardiopathia		
2393	48	"	Sick	Epileptic mania	19. 1. 87.	Epilepsia		
2733	31	"	Weak	Idiotism	22. 7. 93.	Pulmonary Tuberc:		
3237	73	"	Sick	Dementia senilis	19. 5. 03.	Cardiopathia		
2818	58	"	Do.	Epilepsia	9. 1. 95.	Pulmonary Tuberc:		
3244	48	"	Good	Mania	6. 6. 03.	Enteritis		
2969	28	"	Do.	Lypemania	21. 4. 98.	Debility		
3114	67	"	Do.	Do.	19. 7. 00.	Cardiopathia		
1161	78	"	Do.	Erotomania	17. 10. 61.	Debility		
3266	48	"	Sick	Mania	21. 10. 03.	Cerebral softening		
2185	46	"	Good	Delus: mania	4. 3. 84.	Apoplexy		
3239	87	"	Do.	Dementia senilis	26. 5. 03.	General debility		
1250	59	"	Do.	Lypemania	22. 6. 63.	Chronic Ent:		
3276	77	"	Weak	Mania	1. 5. 12. 03.	Maniacal Exhaustion		
2877	41	"	Sick	Epileptic mania	31. 3. 96.	Pulmonary Congestion		
3122	51	"	Good	Lypemania	18. 8. 00.	General debility		
3251	35	"	Do.	Do.	30. 7. 03.	Cardiopathia		
2972	59	"	Do.	Do.	30. 4. 98.	Do.		
212	78	"	Do.	Dementia	5. 2. 53.	Bronchitis		
2878	43	"	Weak	Mania	14. 4. 96.	General debility		
3279	68	"	Good	Senile Insanity	1. 1. 04.	Debility		
3274	42	"	Weak	Delir: Tremens	15. 12. 03.	General debility		
2336	53	"	Do.	Puerperal Mania	22. 6. 86.	Cerebral Congestion		
2735	71	"	Good	Mania	9. 8. 93.	Cardiopathia		

## LUNATIC ASYLUM RETURN, for the year 1903-1904.

## SPACE AND ACCOMMODATION TABLE.

Description of Rooms	Number of each Room	Gross cubic space of all such Rooms		Average amount of cubic space available for each inmate	Average temperature		Amount of Window Space
		Feet	Sq. Feet		Winter	Summer	
Infirmaries & Dormitories *	70	718,927	35,037	1,154			Square Feet 5,134
Day Rooms and Corridors used as Day Rooms	22	578,166	30,653	877	50°		2,660
Single Rooms ...	36	57,647	3,573	1,601			302

\* Including the Infirmary and those forming part of a detached building on the grounds of the Asylum, designed the Agricultural Colony, whose quiet patients chiefly belonging to the agricultural class are kept.

What is the source of the Water Supply; the quality of the water; and the amount of water available for each patient every day?

A natural spring, at a distance from the Asylum; the quality is good, and the quantity available for each patient every day is between 20 and 25 gallons for all services. Water for drinking is supplied under pressure from the aqueduct.

What is the No. of (I.) Lavatories?  
(II.) Baths? †  
(III.) Latrines?

17. (Marble shelves with earthen basins.)  
21. (17 Carrara and 4 porcelain.)  
21. 17 in Wards, and 4 in the airing Courts, the former are built in projection and provided with cross ventilated anterooms and paved with marble. The troughs are provided with ventilating shafts and are flushed periodically and automatically. Those in the yards have Crown basins and are flushed periodically.

What is the system of Sewerage?

A main sewer along and outside the building receives branches from all the latrines, bath rooms, sculleries and wash houses, and discharges its contents on the grounds at a distance from the Asylum. The whole system is provided with ventilating shafts and has an automatic and periodical flushing, and the sewage is used for irrigation.

† A small building in Central Yard is supplied with all necessary hygienic appliances for various purposes.

## Question II. (Management). RESTRAINT.

Restraint	Seclusion under Lock and Key	Restraint by Attendants	Mechanical Restraint
The number of times resorted to...	One		
The number of persons subjected to	One	None	None
The greatest duration of, in any single instance	2h.—25 mins.		

In reference to the above table state:—

I. By whose authority Patients are restrained?

Only seclusion is used and it is ordered in writing by the Medical Officers. These records are examined by the Asylum Board in their weekly meetings.

II. What kinds of mechanical restraint are in use?

None.

III. Whether any, and if any, how many cases of cruelty by attendants to patients have been brought to the notice of the proper authority, and what the result in each case?

One. The attendant abandoned her situation.

IV. What was the number of cases of injury to patients (I.) By themselves?

One. slight.

(II.) By other patients?

Seven. 5 slight and 2 serious.

(III.) By attendants?

One.

(OCCUPATION).

State the extent of  
 (I) The airing Courts.  
 (II) And other grounds.  
 Are the Patients, as a rule, given daily exercise, their health permitting?  
 Are they confined to airing Courts, or allowed to walk in other grounds, and sent beyond the Asylum?  
 Are any means taken to amuse the patients, or to induce them to amuse themselves? Detail them.  
 How many religious services were held during the quarter?  
 What was the average attendance?  
 In what building and how many could it contain?

ACRES I. P.  
 1 — 20 } Belonging to the Asylum.  
 17 2 59 }  
 Yes.

Some are sent beyond the Asylum, others are allowed to walk in the grounds and the remaining are confined to airing Courts.  
 Yes: cards, periodicals, pleasure trips, musical entertainments, occasional fêtes and religious festivals.  
 Religious services are held daily.  
 171. 96 Males and 75 Females.  
 In the Chapel, which is intended to contain about 160.

Daily average number of Patients who were employed during above period.

Distinguishing the Sexes	Specifying the nature of the employment		
	Agriculture and gardening	Trade	Household work, Dressing Water, &c.
Males	47	100	40
Females	—	109	41
	47	209	81
	337		

Question III. (Diet).

*Dietary Table.*

Bread 20 oz. — Meat 4½ oz. — Paste or Rice 3 oz. — Vegetables 1½ ration.  
 Fruit 1 ration — Wine ½ pint — Coffee ½ pint and Sugar ½ oz.

Question IV. (Inspection).

The Patients in the Asylum were divided into the following classes:—

	M.	F.
(I.) Maniacal and Dangerous...	...	...
(II.) Quiet Chronic	128	123
(III.) Melancholy and Suicidal...	128	82
(IV.) Idiotic, Paralytic, Epileptic	46	38
	75	33
	377	276
Remaining on 31st March 1904	653	

LUNATIC ASYLUM RETURN, for the year 1903-1904.

Number of Visits of Inspection paid to the Asylum during the above period.

Distinguishing those visits in which all patients were seen and every part of the building visited, from visits of Partial Inspection	And stating the Official Position of the Visitors							
	By the Governor or Colonial Secretary		By a Government Inspector		By a Committee of the Governing Body		By an Inspector specially charged to ascertain the continued sanity or otherwise of the Patients	
	By Appointment	By Surprise	By Appointment	By Surprise	By Appointment	By Surprise	By Appointment	By Surprise
1. Complete Inspection ...	One by the Governor.		The Comptroller of Charit. Institutions frequently visits the Asylum by appointment and by surprise. The Chief Govt Medical Officer visited the Asylum once a month.		A Board inspects the Asylum once every week.		This duty is performed by the Visiting Physician who attends three times a week. A Board meets weekly to admit and discharge patients.	
2. Partial Inspection ...	None.							

State how many reports of the following kinds have come under the notice of the Governor :—

(I.) Financial and Statistical (showing, amongst other things, on what system the Money and Store Accounts are kept and audited).

(I.) The Comptroller of Charitable Institutions renders his Money Accounts, monthly to the Auditor General, and a Store Account, annually, in the form prescribed by the Colonial Regulations:

(II.) Reports by the person or persons charged with the immediate management of the Asylum.

(II.) The officers in charge of the Asylum send weekly, monthly, quarterly and annual statistical returns and monthly financial reports to the Comptroller of the Charitable Institutions as also several other reports regarding the management of the Asylum.

(III.) Reports by an Official Inspector independent of the Governing body of the Asylum.

(III.) The Comptroller of Charitable Institutions performs this duty, and reports to Government the result of his inspection, when necessary.

Question I. (Statistical).  
GENERAL STATISTICAL TABLE.

Remaining on 31st March 1903		Number admitted during above period	Daily average Number during above period	Number of Attendants		Discharged				Total	Remaining on 31st March 1904
Sex	No.			Resident	Non-Resident	Attendance of day	Withdrawal	For misconduct	Death		
Males . . . . .	35	3	37	4	6	1	1	1	—	3	35
Females . . . . .	54	7	52	7	2	7	5	—	—	12	49
Totals . . . . .	89	10	89	11	8	8	6	1	—	15	84

\* Sisters of Charity who perform duty in Female Division.

SPACE AND ACCOMMODATION TABLE.

Description of Rooms	Number of such Rooms	Gross cubic space of all such Rooms	Gross superficial area of all such Rooms	Average amount of cubic space available for each inmate	Average temperature		Amount of Window Space
					Summer	Winter	
Dormitories [Male Division]	3 (Infirmary included)	98,662	4,732	2,666	90	54	575
Do. [Female Do.]	1	106,299	4,572	2,044	90	54	472
Day Room [Male Do.]	1 (Chapel included)	114,174	5,677	3,085	90	54	525
Do. [Female Do.]	4	164,072	6,936	3,155	90	54	574
Yards of play grounds [Male Do.]	2	—	2,747	—	—	—	—
Do. [Female Do.]	1	—	4,953	—	—	—	—

What is the source of the Water Supply; the quality of the water; and the amount of water available for each patient every day?

The potable water is conveyed from a natural spring to a storage reservoir at about  $4\frac{1}{2}$  miles from the town, and thence by an iron main to the Asylum. The second quality water is pumped from a natural spring at about three miles from the town to a feeding tank in Valletta, and thence distributed through iron pipes. Any quantity is available, as the building is directly connected with the aqueducts.

What is the Number of (I.) Lavatories?

- (II.) Baths?  
(III.) Latrines?

Two sets (earthenware basins fixed on marble slabs) one in each division.

Two. Porcelain.

Two. Six Crown basins with waste water preventors. (Three in each division).

What is the system of Sewerage?

Water system. The privies are separated from the Wards by ventilated anterooms.

## ORPHAN ASYLUM RETURN, for the year 1903-1904.

## Question II.

Daily average number of inmates who were apprenticed to Trades and Industrial Occupations during above period.

Sexes	Occupation and number of inmates who, on discharge, obtained employment			
	Household work &c.	Apprentices in Trades		Number of those who, on discharge, obtained employment
		In the Asylum	Out of the Asylum	
Males ... ..	All the boys by turn.	2	5	Males—one plumber and one Tailor.
Females ... ..	Washing, ironing, sewing, cooking and dress-making by turn.	24	—	Females—three employed as Servants.

## Question III. (Diet).

## Dietary Table.

Bread 20 oz.—Meat oz.  $\frac{3}{4}$ —Paste or Rice 2 oz.—Vegetables  $1\frac{1}{2}$  ration

Milk pint  $\frac{1}{2}$ —Coffee\* pint  $\frac{1}{2}$ —Sugar oz.  $\frac{2}{3}$ —Fruit rations 2

Wine for Orphans employed in trades or household work oz. 4—Bread 5 oz.—Fruit  $1\frac{1}{2}$  ration.

\* Tea is now given instead of Coffee.

## Question IV. (Inspection).

Number of Visits of Inspection paid to the Asylum during the above period.

Distinguishing those visits in which all inmates were seen and every part of the building visited, from visits of Partial Inspection	and stating the Official Position of the Visitors							
	By the Governor or Colonial Secretary		By a Government Inspector		By a Committee of the Governing Body		By an Inspector specially charged to ascertain the state of health of the inmates	
	By Appointment	By Surprise	By Appointment	By Surprise	By Appointment	By Surprise	By Appointment	By Surprise
1. Complete Inspection ...	Once by His Excellency the Governor & once by the Lieutenant Governor.		The Compt. of Char. Inst. visits often the Asylum by surprise. The Chief Govt. M. Officer visited the Asylum four times.		Twice by the Commissioners of Charity.		This duty is performed by a Medical Attendant who visits the Asylum twice a day.	
2. Partial Inspection ...								

Section II (Continued)

For the purpose of this report, the following data were collected:

Date	Description	Amount	Remarks
Jan 1	Balance forward	100.00	
Jan 15	Cash received	50.00	
Jan 30	Cash received	25.00	
Feb 1	Cash received	75.00	
Feb 15	Cash received	30.00	
Feb 28	Cash received	100.00	
Total		380.00	

Section III (Continued)

The following table shows the results of the experiments conducted during the year:

Section IV (Continued)

The following table shows the results of the experiments conducted during the year:

Date	Description	Amount	Remarks	Total
Jan 1	Balance forward	100.00		100.00
Jan 15	Cash received	50.00		150.00
Jan 30	Cash received	25.00		175.00
Feb 1	Cash received	75.00		250.00
Feb 15	Cash received	30.00		280.00
Feb 28	Cash received	100.00		380.00
Total		380.00		380.00



- LUNATIC ASYLUM -

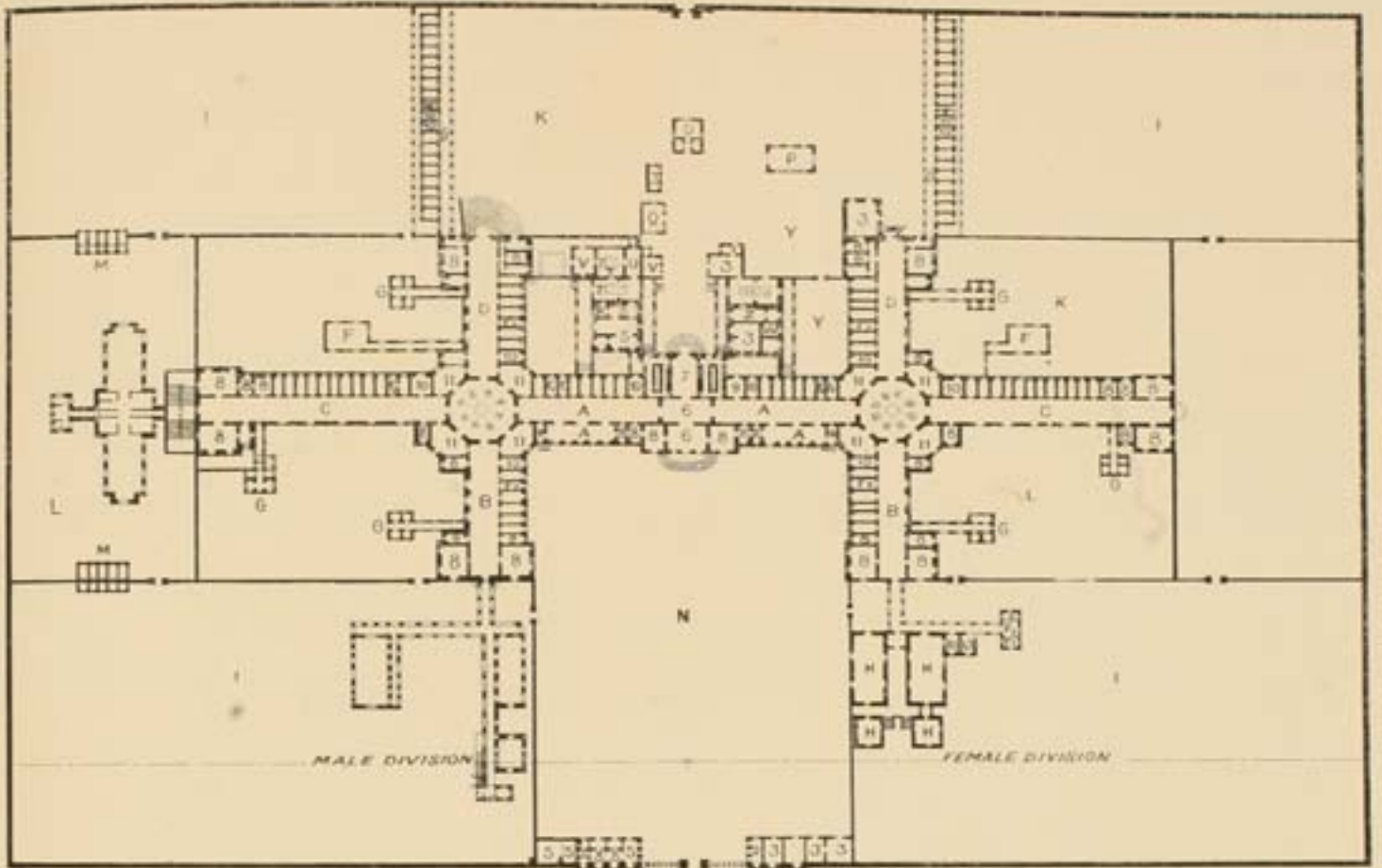

- |  |   |  |   |
|--|---|--|---|
| <p><b>A.</b> Refectories for Wards, Nos. 1 &amp; 2.</p> <p><b>B.</b> Gallery and Refectory, single and associated bed-rooms for Epileptics and Idiots.</p> <p><b>C.</b> Gallery and single and associated bed-rooms for tranquil and convalescent patients.</p> <p><b>D.</b> Gallery and Refectory and associated rooms for criminal, dangerous and violent patients.</p> <p><b>D.1</b> Gallery and single rooms for noisy patients.</p> <p><b>E.</b> Rotunda Day room.</p> <p><b>F.</b> Bath room.</p> <p><b>F.1</b> Bath room.</p> <p><b>F.2</b> Lavatory</p> <p><b>G.</b> W. C.</p> <p><b>H.</b> Infirmary</p> <p><b>I.</b> Lands</p> | <p><b>K.</b> Airing court for dangerous and violent cases.</p> <p><b>L.</b> Airing court for tranquil and convalescent patients.</p> <p><b>M.</b> Poultry house.</p> <p><b>N.</b> Main yard.</p> <p><b>O.</b> Douche Apparatus room.</p> <p><b>P.</b> Covered place for drying clothes.</p> <p><b>Q.</b> Cook's room.</p> <p><b>R.</b> Scullery M. D.</p> <p><b>S.</b> Scullery F. D.</p> <p><b>S.1</b> Store for provisions.</p> <p><b>T.</b> Kitchen.</p> <p><b>T.1</b> Spare Kitchen.</p> <p><b>U.</b> Bakery.</p> <p><b>V.</b> Steam engine house.</p> <p><b>W.</b> Patients' effects store.</p> <p><b>X.</b> Wash house.</p> <p><b>Y.</b> Yard for drying clothes.</p> <p><b>Z.</b> Clean linen store.</p> | <p><b>1.</b> Main entrance.</p> <p><b>2.</b> Gate keeper's room.</p> <p><b>3.</b> Workshops.</p> <p><b>4.</b> Dead-room.</p> <p><b>5.</b> Storekeeper's quarters.</p> <p><b>6.</b> Entrance Hall.</p> <p><b>7.</b> Superintendent's office.</p> <p><b>8.</b> Dormitory.</p> <p><b>9.</b> Dispensary.</p> <p><b>10.</b> Attendant's room.</p> <p><b>11.</b> Observation dormitory.</p> <p><b>12.</b> Padded room.</p> <p><b>13.</b> Store for bedding and clothing.</p> | <p align="center"><b>AGRICULTURAL COLONY BUILDING.</b></p> <p><b>A.</b> Day room.</p> <p><b>B.</b> Dormitory.</p> <p><b>C.</b> Attendant's room.</p> <p><b>D.</b> Store for bedding and clothing.</p> <p><b>E.</b> Head Attendant's room.</p> <p><b>F.</b> Lavatory.</p> <p><b>G.</b> W. C.</p> <p><b>H.</b> Bath.</p> <p><b>I.</b> Airing court.</p> <p><b>K.</b> Refectory.</p> <p><b>L.</b> W. C. and Lavatory</p> <p><b>M.</b> Boiler room and scullery.</p> <p><b>N.</b> Land labourers' room.</p> <p><b>O.</b> Pigsty.</p> <p><b>P.</b> Cow house.</p> <p><b>Q.</b> Watch room.</p> |
|--|---|--|---|

