

V

LUNATIC ASYLUM

AND

ORPHAN ASYLUM

1905-1906.

LUNATIC ASYLUM RETURN, for the year 1905-1906.

Question I. (Statistical).  
GENERAL STATISTICAL TABLE.

	Remaining in 1st March 1905	Number Admitted during above period	Daily Average Number during above period	Number of Admissions				Discharges				Number of Patients who died in above period	Average Stay of those			
				Resident		New Resident		Cured	Relieved	Not Improved	Not subject to the Asylum		Died in above period	Discharged in above period	Remaining on 1st March 1906	Remaining on 1st March 1906
				Employed in Attendance on the Patients	Employed as servants or only partially in Attendance	Employed in Attendance on the Patients	Employed as servants or only partially in Attendance									
Male...	323	70	386	27	6	4	9	16	9	9	10	29	3248	154	4324	385
Female	275	60	285	25*	3†	1	4	11	17	4	3	12	2227	837	4123	291
Totals	663	130	672	52	9	5	13	24	26	13	13	41	—	—	—	676

\* Six are Sisters of Charity who perform duty only in the Female Division.

† One is a Sister of Charity in charge of the Wash-house.

OBITUARY TABLE.

Number of deceased on Register	Age of deceased	Sex of deceased	Daily condition when admitted	Form of Mental Disorder	Date of Admission	Cause of Death	State whether a Coroner's Inquest was held and what was the Verdict	State whether a Post Mortem Examination was held
4526	28	M.	Sick	Delirium Tremens	2. 4. 905	Delirium Tremens		
4544	50	"	Do.	Alcoholic Delirium	23. 4. 905	Delirium Tremens		
4227	49	"	Good	Imbecility	2. 10. 904	Enteritis		
4491	45	"	Weak	Epileptic Insanity	19. 9. 904	Epilepsy		
1244	72	"	Good	Dementia	12. 4. 858	Debility		
4194	26	"	Do.	Delusional Mania	11. 5. 904	Enteritis		
3739	53	"	Do.	Delusional Mania	7. 3. 896	Cerebral Embolism		
4551	29	"	Weak	Melancholia	2. 6. 905	Enteritis		
3512	45	"	Do.	Epileptic Mania	21. 3. 893	Enteritis		
4589	33	"	Good	Megastomania	14. 8. 903	General Paralysis		
3108	49	"	Do.	Delusional Mania	5. 12. 887	Enteritis		
4300	38	"	Weak	Mania	19. 10. 904	Debility		
4541	60	"	Do.	Delirium Tremens	6. 4. 905	Apoplexy		
4557	72	"	Sick	Dementia	8. 7. 905	Apoplexy		
7231	69	"	Good	Mania	1. 2. 882	Cardiopathy		
3959	59	"	Do.	Lypomania	8. 10. 894	Cerebral Congestion		
4473	39	"	Sick	Syphilitic Insanity	5. 7. 904	Cerebral Syphilis		
4090	46	"	Weak	Unclassified	3. 12. 905	Alcoholism		
4575	37	"	Do.	Unclassified	8. 10. 905	Epilepsy	No	No
4130	37	"	Do.	Epilepsy	27. 8. 900	Epilepsy		
4143	53	"	Good	Delusional Mania	18. 9. 900	Abscess of the Liver		
4912	64	"	Do.	Dementia	30. 11. 869	Cardiopathy		
3605	53	"	Do.	Dementia	2. 10. 892	Enteritis		
4581	40	"	Weak	Confusional Insanity	7. 11. 905	Cerebral Syphilis		
4454	78	"	Do.	Senile Dementia	26. 4. 904	Cardiopathy		
1875	73	"	Good	Mania	4. 7. 858	Gonorrhoe		
4596	55	"	Weak	Dementia	19. 2. 905	Enteritis		
3541	85	"	Good	Dementia	19. 6. 853	Debility		
3906	58	"	Do.	Mania	19. 3. 894	Apoplexy		
3154	54	F.	Weak	Delusional Mania	4. 4. 901	Cardiopathy		
3249	72	"	Good	Delusional Insanity	24. 7. 905	Cardiopathy		
3355	62	"	Weak	Mania	2. 6. 905	Debility		
3281	41	"	Good	Mania	16. 1. 904	Cerebral Congestion		
4530	61	"	Do.	Dementia	13. 9. 869	Cardiopathy		
3362	20	"	Sick	Hysterical Mania	23. 7. 905	Pulmonary Tuberculosis		
3243	33	"	Good	Lypomania	2. 8. 903	Pulmonary Tuberculosis		
4778	71	"	Do.	Delusional Mania	18. 4. 894	Cardiopathy		
3916	35	"	Weak	Mania	28. 4. 897	Pulmonary Tuberculosis		
3686	49	"	Good	Imbecility	7. 2. 900	Debility		
3111	74	"	Sick	Lypomania	5. 8. 904	Cardiopathy		
3395	77	"	Weak	Dementia	20. 2. 906	Cerebral Congestion		

## LUNATIC ASYLUM RETURN, for the year 1905-1906.

SPACE AND ACCOMMODATION TABLE.

Description of Rooms	Number of each Room	Gross cubic space of all such Rooms	Gross superficial area of all such Rooms	Average amount of cubic space available for each inmate	Average temperature		Amount of Window Space
					Winter	Summer	
Infirmaries & Dormitories *	71	719,639	35,635	1,086			Square Feet 5,497
Day Rooms and Corridors used as Day Rooms	22	375,166	10,653	827	50°	67°	2,660
Single Rooms ... ..	30	57,947	3,373	1,601			302

\* Including the Tuberoles and those forming part of a detached building on the grounds of the Asylum, designated the Agricultural Colony, whose special patients chiefly belonging to the agricultural class are kept.

What is the source of the Water supply; the quality of the water; and the amount of water available for each patient every day;

A natural spring, at a distance from the Asylum; the quality is good, and the quantity available for each patient every day is between 20 and 25 gallons for all services. Water for drinking is supplied under pressure from the aqueduct.

What is the No. of (I.) Lavatories?  
(II.) Baths? †  
(III.) Latrines?

22. (Marble shelves with earthen basins.)  
22. (17 Carrara and 5 porcelain.)  
27. (21 in Wards, and 6 in the airing Courts, the former are built in projection and provided with cross ventilated anterooms and paved with marble. The troughs are provided with ventilating shafts and are flushed periodically and automatically. Those in the yards have Crown basins and are flushed periodically.)

What is the system of Sewerage?

A main sewer along and outside the building receives branches from all the latrines, bath rooms, sculleries and wash houses, and discharges its contents on the grounds at a distance from the Asylum. The whole system is provided with ventilating shafts and has an automatic and periodical flushing, and the sewage is used for irrigation.

† A small building in Court of Yard is supplied with all necessary hygienic appliances for sanitary purposes.

Question II. (Management).  
RESTRAINT.

Reasons	Seclusion under Lock and Key	Emersion by Attendants	Medical Treatment
The number of times resorted to...	1		
The number of persons subjected to	1	None	None
The greatest duration of, in any single instance	3½ hours		

In reference to the above table state:—

I. By whose authority Patients are restrained?

Only seclusion is used and it is ordered in writing by the Medical Officers. These records are examined by the Asylum Board in their weekly meetings.

None.

II. What kinds of mechanical restraint are in use?

Two. The attendants were dismissed from the services.

III. Whether any, and if any, how many cases of cruelty by attendants to patients have been brought to the notice of the proper authority, and what the result in each case?

IV. What was the number of cases of injury to patients (I.) By themselves?

Five slight. Four serious.

(II.) By other patients?

Two slight. One serious.

(III.) By attendants?

None.

LUNATIC ASYLUM RETURN, for the year 1905-1906.

(OCCUPATION).

State the extent of  
 (I) The airing Courts.  
 (II) And other grounds.  
 Are the Patients, as a rule, given daily exercise, their health permitting.  
 Are they confined to airing Courts, or allowed to walk in other grounds, and sent beyond the Asylum?  
 Are any means taken to amuse the patients, or to induce them to amuse themselves? Detail them.  
 How many religious services were held during the quarter?  
 What was the average attendance?  
 In what building and how many could it contain?

ACRES I. P.  
 1 - 20 }  
 17 2-59 } Belonging to the Asylum.  
 Yes.

Some are sent beyond the Asylum, others are allowed to walk in the grounds and the remaining are confined to airing Courts.  
 Yes: cards, periodicals, pleasure trips, musical entertainments, occasional fêtes and religious festivals.  
 Religious services are held daily.  
 153. 89 Males and 64 Females.  
 In the Chapel, which is intended to contain about 160.

Daily average number of Patients who were employed during above period.

Distinguishing the Sexes	Specifying the nature of the employment		
	Agriculture and gardening	Trades	Household work, Dressing, Washing, &c.
Males	45	107	44
Females	—	92	40
	45	199	84
	328		

Question III. (Diet).

*Dietary Table.*

Bread 20 oz. — Meat 4½ oz. — Paste or Rice 3 oz. — Vegetables 1¼ ration.  
 Fruit 1 ration — Wine ¼ pint — Coffee ½ pint and Sugar ½ oz.

Question IV. (Inspection).

The Patients in the Asylum were divided into the following classes:—

(I.) Maniacal and Dangerous...	...	...	...	112	145
(II.) Quiet Chronic	...	...	...	126	74
(III.) Melancholy and Suicidal...	...	...	...	47	39
(IV.) Idiotic, Paralytic, Epileptic	...	...	...	80	33
				385	291
Remaining on 31st March 1906	...	...	...	676	

## LUNATIC ASYLUM RETURN, for the year 1905-1906.

Number of Visits of Inspection paid to the Asylum during the above period.

Distinguishing those visits in which all patients, servants and every part of the building visited, from visits of partial inspection	and stating the Official Position of the Visitors							
	By the Governor or Colonial Secretary		By a Government Inspector		By a Committee of the Governing Body		By an Inspector specially charged to ascertain the economical Economy or otherwise of the Patients	
	By Appointment	By Surprise	By Appointment	By Surprise	By Appointment	By Surprise	By Appointment	By Surprise
1. Complete Inspection...	One by H. E. the Governor.		The Comptroller of Charit. Institutions frequently visits the Asylum by appointment and by surprise. The Chief Govt. Medical Officer visited the Asylum once a month.		A Board inspects the Asylum once every week.		This duty is performed by the Visiting Physician who attends three times a week. A Board meets weekly to admit and discharge patients.	
2. Partial Inspection ...	None.							

State how many reports of the following kinds have come under the notice of the Governor:—

(I.) Financial and Statistical (showing, amongst other things, on what system the Money and Store Accounts are kept and audited).

(II.) Reports by the person or persons charged with the immediate management of the Asylum.

(III.) Reports by an Official Inspector independent of the Governing body of the Asylum.

(I.) The Comptroller of Charitable Institutions renders his Money Accounts, monthly to the Auditor General, and a Store Account, annually, in the form prescribed by the Colonial Regulations.

(II.) The officers in charge of the Asylum send weekly, monthly, quarterly and annual statistical returns and monthly financial reports to the Comptroller of Charitable Institutions as also several other reports regarding the management of the Asylum.

(III.) The Comotroller of Charitable Institutions performs this duty, and reports to Government the result of his inspection, when necessary.

Question I. (Statistical).  
GENERAL STATISTICAL TABLE.

Remaining on 31st March 1904.		Number admitted during above period.	Daily average Number during above period.	Number of Asylums.		Discharged				Total	Remaining on 31st March 1906.
						Resident	New Residents	Attendants of age	Withdrawn		
Sex	Do.										
Males ...	39	2	35	4	6	4	—	—	1	5	36
Females ...	42	7	43	0	2	2	3	—	—	5	44
Totals ...	81	9	81	11	8	6	3	—	1	10	80

\* Sisters of Charity who perform duty in Female Division.

## SPACE AND ACCOMMODATION TABLE.

Description of Rooms	Number of such Rooms	Gross cubic space of all such Rooms	Gross superficial area of all such Rooms	Average amount of cubic space available for each inmate	Average temperature		Amount of Window Space
					Summer	Winter	
Dormitories [Male Division]	1	Foot	Square Feet	Feet	90	50	Square Feet
Do. [Female Do.]	1	95,662	4,732	2,595	90	50	575
Day Room [Male Do.]	1	106,299	4,572	2,262	90	50	472
Do. [Female Do.]	4	114,174	5,077	3,004	90	50	525
Yards of play grounds [Male Do.]	2	164,072	6,936	1,491	90	50	374
Do. [Female Do.]	1	—	2,747	—	—	—	—
	1	—	4,953	—	—	—	—

What is the source of the Water Supply; the quality of the water; and the amount of water available for each patient every day?

The potable water is conveyed from a natural spring to a storage reservoir at about  $4\frac{1}{2}$  miles from the town, and thence by an iron main to the Asylum. The second quality water is pumped from a natural spring at about three miles from the town to a feeding tank in Valletta, and thence distributed through iron pipes. Any quantity is available, as the building is directly connected with the aqueducts.

Two sets (earthenware basin fixed on marble slabs) one in each division.

Two. Porcelain.

Two. Six Crown basins with waste water preventors. (Three in each division).

Water system. The privies are separated from the Wards by ventilated anterooms.

What is the Number of (I.) Lavatories?

(II.) Baths?  
(III.) Latrines?

What is the system of Sewerage?

ORPHAN ASYLUM RETURN, for the year 1905-1906.

Question II.

Daily average number of inmates who were apprenticed to Trades and Industrial Occupations during above period.

Sexes	Occupation and number of inmates who, on discharge, obtained employment			
	Household work &c.	Apprentices in Trades		Number of those who, on discharge, obtained employment
		In the Asylum	Out of the Asylum	
Males	All the boys by turn.	1	2	Males—one shoemaker, one tailor, and one boy sorter in the Post Office.
Females	Washing, ironing, sewing, cooking and dress-making by turn.	24	--	Females— one employed as Servant.

Question III. (Diet).

Dietary Table.

Bread 20 oz.—Meat oz.  $\frac{3}{4}$ —Paste or Rice 2 oz.—Vegetables  $1\frac{1}{2}$  ration  
 Milk pint  $\frac{1}{2}$ —Coffee\* pint  $\frac{1}{2}$ —Sugar oz.  $\frac{3}{4}$ —Fruit rations 2  
 Wine for Orphans employed in trades or household work oz. 4—Bread 5 oz.—Fruit 1 ration.

\* Tea is now given instead of Coffee.

Question IV. (Inspection).

Number of Visits of Inspection paid to the Asylum during the above period.

Distinguishing those visits in which all inmates were seen and every part of the building visited, from those of Partial Inspection	and stating the Official Position of the Visitors							
	By the Governor of Ontario		By a Government Inspector		By a Committee of the Governing Body		By an Inspector specially charged to ascertain the state of health of the inmates	
	By Appointment	By Surprise	By Appointment	By Surprise	By Appointment	By Surprise	By Appointment	By Surprise
1. Complete Inspection ...	None.		The Compt. of Char. Inst. visits often the Asylum by surprise. The Chief Govt. M. Officer visited the Asylum four times.		Twice by the Commissioners of Charity.		This duty is performed by a Medical Attendant who visits the Asylum once a day, and oftener when required.	
2. Partial Inspection ...								





# LUNATIC ASYLUM.

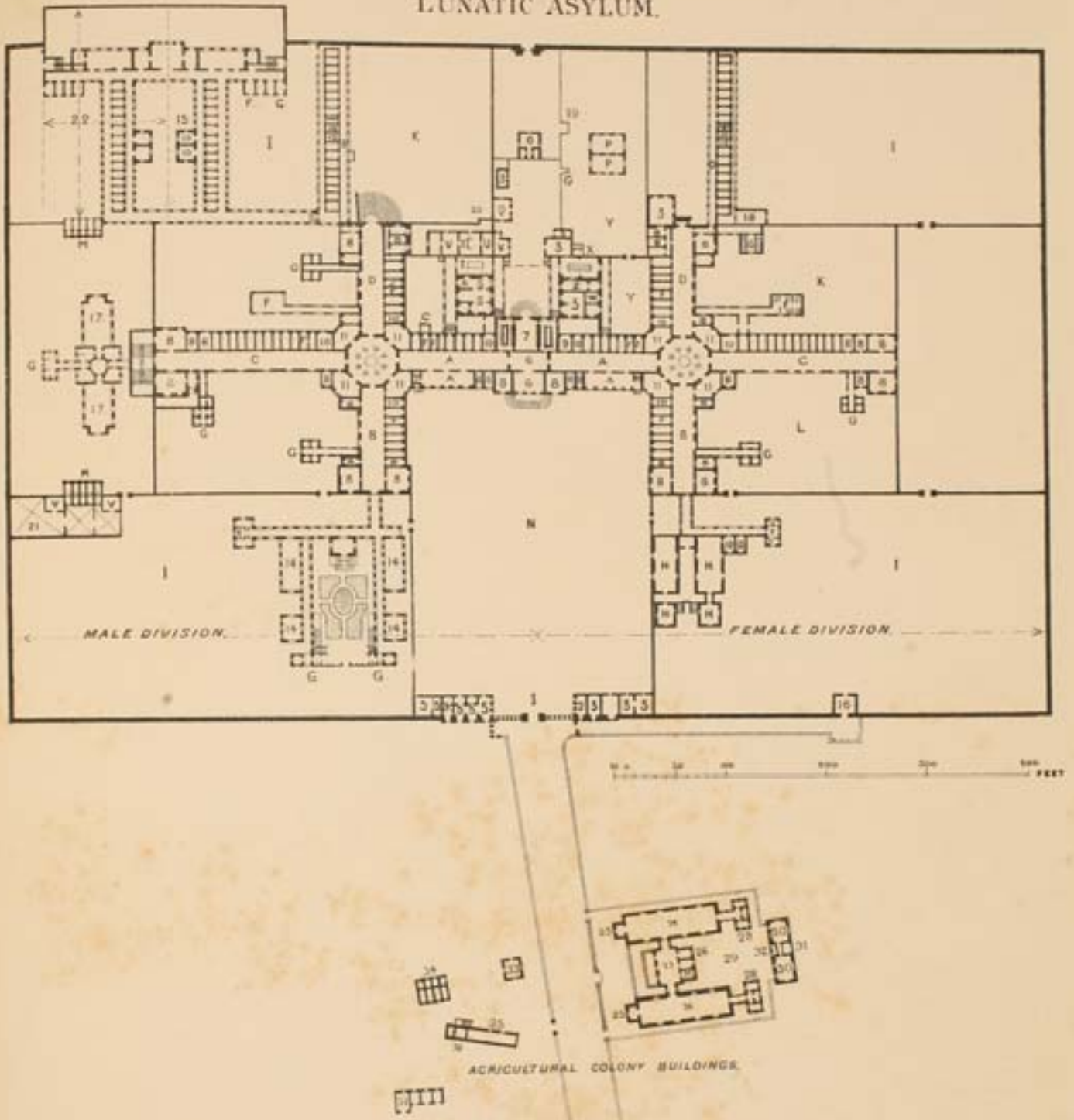

- A. Refectory for Wards Nos. 1 & 3.
- B. Gallery, refectory and bed-room for epileptics.
- C. Gallery and bed-rooms for quiet and convalescent patients.
- D. Gallery and refectory for criminal and violent patients.
- E. Day room.
- F. Bath room and lavatory.
- G. W. C.
- H. Infirmary.
- I. Open space.
- K. Court for dangerous & violent patients.
- L. Court for quiet & convalescent patients.
- M. Poultry house.
- N. Main yard.

- O. Douche apparatus.
- P. Covered yard.
- Q. Cook's room.
- R. Scullery.
- S. Store.
- T. Kitchens.
- U. Bakery.
- V. Steam engine.
- W. Store.
- X. Wash house.
- Y. Yard.
- Z. Store.
- 1. Main entrance.
- 2. Gate keeper's room.
- 3. Workshop.
- 4. Mortuary.
- 5. Storekeeper's quarters.

- 6. Entrance Hall.
- 7. Superintendent's office.
- 8. Dormitory.
- 9. Dispensary.
- 10. Attendant's room.
- 11. Observation Dormitory.
- 12. Padded room.
- 13. Store.
- 14. Infirmary.
- 15. Criminal ward.
- 16. Mortuary.
- 17. Observation ward.
- 18. Guard room.
- 19. Store.
- 20. Bakery.
- 21. Goat-shed.
- 22. Observation ward in course of construction.

## AGRICULTURAL COLONY BUILDINGS.

- 23. Day room.
- 24. Dormitory.
- 25. Attendant's room.
- 26. Store.
- 27. Head attendant's room.
- 28. W. C., Lavatory and Bath.
- 29. Airing court.
- 30. Refectory.
- 31. W. C. and Lavatory.
- 32. Boiler room and Scullery.
- 33. Land labourer's room.
- 34. Pigsty.
- 35. Cow-shed.
- 36. Watch room.
- 37. Stable.

