

V

LUNATIC ASYLUM

AND

ORPHAN ASYLUM

1906-1907.

LUNATIC ASYLUM RETURN, for the year 1906-1907.

Question I. (Statistical).

GENERAL STATISTICAL TABLE.

	Remaining on 31st March 1906	Number Admitted during above period	Daily Average Number during above period	Number of Attendants				Discharges				Number of Patients who died in above period	Average Stay of those			Remaining on 31st March 1907
				Resident		Non-Resident		Cured	Relieved	Not improved	Not objects for the Asylum		Dead in above period	Discharged in above period	Remaining on 31st March 1907	
				Employed in Attendance on the Patients	Employed as Servants or only partially as Attendants	Employed in Attendance on the Patients	Employed as Servants or only partially as Attendants									
Male...	385	101	406	27	6	4	9	26	10	11	4	24	3067	459	4166	411
Female	291	56	299	25*	3†	1	4	12	9	9	—	19	4813	295	4034	298
Totals	676	157	705	52	9	5	13	38	19	20	4	43	—	—	—	709

* Six are Sisters of Charity who perform duty only in the Female Division.

† One is a Sister of Charity in charge of the Wash-house.

OBITUARY TABLE.

Number of deceased on Register	Age of deceased	Sex of deceased	bodily condition when admitted	Form of Mental Disorder	Date of Admission	Cause of Death	State whether a Coroner's Inquest was held and what was the Verdict	State whether a Post Mortem Examination was held
3375	50	M.	Sick	Epileptic Insanity	5. 6. 91	Epilepsy		
4028	64	"	Do.	Confusional Insanity	29. 5. 906	Cerebral Congestion		
3472	77	"	Good	Mania	13. 8. 92	Debility		
4065	87	"	Weak	Recurrent Mania	3. 11. 99	Do.		
4586	68	"	Do.	Delusional Mania	28. 10. 905	Do.		
4427	18	"	Do.	Imbecility	9. 1. 904	Pulmonary Tuberculosis		
4393	31	"	Good	Lypomania	25. 5. 903	Do.		
4668	32	"	Sick	Alcoholism	2. 10. 906	Alcoholism		
1547	67	"	Good	Dementia	2. 10. 62	Apoplexy		
3694	51	"	Do.	Delusional Mania	21. 5. 95	Nephritis		
2324	70	"	Do.	Mania	19. 12. 76	Cerebral Congestion		
4614	48	"	Do.	Delusional Insanity	27. 4. 906	Enteritis		
3045	57	"	Sick	Moral Insanity	7. 3. 87	Cerebral Congestion		
4697	52	"	Weak	Unclassified	24. 1. 907	Do.		
4523	72	"	Do.	Dementia	24. 1. 905	Cardiopathy		
4635	72	"	Sick	Alcoholism	20. 6. 906	Do.		
4659	58	"	Weak	Melancholia	22. 8. 906	Abscess of the Liver		
4523	62	"	Sick	Epileptic Insanity	17. 5. 906	Cardiopathy		
4794	71	"	Do.	Unclassified	3. 3. 907	Do.		
3595	31	"	Do.	Epileptic Mania	14. 2. 94	Epilepsy	No	No
2027	61	"	Good	Do.	7. 11. 71	Do.		
4594	67	"	Weak	Delusional Insanity	9. 1. 906	Debility		
4378	36	"	Sick	Idiotism	16. 10. 901	Epilepsy		
4939	46	"	Do.	General Paralysis	26. 6. 906	Gen. Paralysis of the Insane		
2847	29	F.	Good	Mania	10. 8. 95	Br. Pneumonia from Scalds		
1949	53	"	Sick	Delusional Mania	24. 7. 79	Cardiopathy		
3394	37	"	Do.	Unclassified	9. 2. 906	Erysipelas		
3410	23	"	Do.	Mania	26. 4. 906	Pulmonary Tuberculosis		
2796	68	"	Weak	Delusional Mania	1. 8. 94	Cardiopathy		
3178	31	"	Do.	Lypomania	21. 11. 901	Pulmonary Tuberculosis		
2928	57	"	Good	Imbecility	7. 8. 97	Enteritis		
2814	59	"	Do.	Mania	13. 11. 94	Cardiopathy		
3309	44	"	Sick	Melancholia	15. 7. 904	Enteritis		
2450	57	"	Good	Mania	8. 2. 88	Cardiopathy		
2168	65	"	Do.	Delusional Mania	14. 4. 84	Enteritis		
3369	49	"	Do.	Do.	23. 8. 905	Cardiopathy		
2549	42	"	Do.	Mania	22. 8. 89	Do.		
751	81	"	Do.	Lypomania	12. 10. 53	Cerebral Congestion		
3302	25	"	Weak	Imbecility	33. 6. 904	Pulmonary Tuberculosis		
1684	74	"	Do.	Lypomania	22. 10. 73	Cardiopathy		
2967	87	"	Good	Delusional Mania	15. 4. 98	Do.		
3110	75	"	Do.	Lypomania	4. 7. 900	Debility		
2895	69	"	Sick	Imbecility	16. 9. 96	Epilepsy		

LUNATIC ASYLUM RETURN, for the year 1906-1907.

SPACE AND ACCOMMODATION TABLE.

Description of Rooms	Number of such Rooms	Gross cubic space of all such Rooms	Gross superficial area of all such Rooms	Average amount of cubic space available for each inmate	Average temperature		Amount of Window Space
					Winter	Summer	
Infirmaries & Dormitories *	71	749,639	35,658	1,086			Square Feet 5,407
Day Rooms and Corridors used as Day Rooms	22	578,166	30,653	877	50°	67°	2,660
Single Rooms	36	57,647	3,573	1,601			302

* Including the Infirmaries and those forming part of a detached building on the grounds of the Asylum, designated the Agricultural Colony where quiet patients chiefly belonging to the agricultural class are kept.

What is the source of the Water supply; the quality of the water; and the amount of water available for each patient every day;

A natural spring, at a distance from the Asylum; the quality is good, and the quantity available for each patient every day is between 20 and 25 gallons for all services. Water for drinking is supplied under pressure from the aqueduct.

What is the No. of (I.) Lavatories?
(II.) Baths? †
(III.) Latrines?

22. (Marble shelves with earthen basins).

22. (17 Carrara and five porcelain).

27. (21 in Wards, and 6 in the airing

* Courts), the former are built in projection and provided with cross ventilated anterooms and paved with marble. The troughs are provided with ventilating shafts and are flushed periodically and automatically. Those in the yards have Crown basins and are flushed periodically.

What is the system of Sewerage?

A main sewer along and outside the building receives branches from all the latrines, bath rooms, sculleries and wash houses, and discharges its contents on the grounds at a distance from the Asylums. The whole system is provided with ventilating shafts and has an automatic and periodical flushing, and the sewage is used for irrigation.

† A small building in Central Yard is supplied with all necessary hydropathic appliances for curative purposes.

Question II. (Management). RESTRAINT.

Restraint	Seclusion under Lock and Key	Restraint by Attachments	Mechanical Restraint
The number of times resorted to...			
The number of persons subjected to	None	None	None
The greatest duration of, in any single instance			

In reference to the above table state:—

I. By whose authority Patients are restrained?

Only seclusion is used and it is ordered in writing by the Medical Officers. These records are examined by the Asylum Board in their weekly meetings.

None.

II. What kinds of mechanical restraint are in use?

One. The attendant was dismissed from the service.

III. Whether any, and if any, how many cases of cruelty by attendants to patients have been brought to the notice of the proper authority, and what the result in each case?

IV. What was the number of cases of injury to patients (I.) By themselves?

(II.) By other patients?

(III.) By attendants?

Two slight Three serious accidental

Three slight Two serious.

None.

LUNATIC ASYLUM RETURN, for the year 1906-1907.

(OCCUPATION).

State the extent of

(I) The airing Courts.

(II) And other grounds.

Are the Patients as a rule, given daily exercise, their health permitting?

Are they confined to airing Courts, or allowed to walk in other grounds, and sent beyond the Asylum?

Are any means taken to amuse the patients, or to induce them to amuse themselves? Detail them.

How many religious service were held during the quarter?

What was the average attendance?

In what building and how many could it contain?

ACRES I. P.

1 — 20

17 2 59

Yes

} Belonging to the Asylum.

Some are sent beyond the Asylum, others are allowed to walk in the grounds and the remaining are confined to airing Courts.

Yes: cards periodicals, pleasure trips, musical entertainments, occasional fêtes and religious festivals.

Religious services are held daily.

152. 94 Males and 58 Females.

In the Chapel, which is intended to contain about 160.

Daily average number of Patients who were employed during above period.

Distinguishing the Sexes	Specifying the nature of the employment		
	Agriculture and gardening	Trade	Household work, Drawing Water &c.
Males	43	110	46
Females	—	85	42
	43	195	88
	326		

Question III. (Diet).

Dietary Table.

Bread 20 oz. — Meat 4½ oz. — Paste or Rice 3 oz. — Vegetables 1½ ration.
Fruit 1 ration — Wine ¼ pint — Coffee ½ pint and Sugar ½ oz.

Question IV. (Inspection).

The Patients in the Asylum were divided into the following classes:—

(I.) Maniacal and Dangerous...	M.	104	F.	114
(II.) Quiet Chronic	171	...	118
(III.) Melancholy and Suicidal...	50	...	32
(IV.) Idiotic, Paralytic, Epileptic	86	...	34
				411		298
Remaining on 31st March 1907	709		

LUNATIC ASYLUM RETURN, for the year 1906-1907.

Number of Visits of Inspection paid to the Asylum during the above period.

Distinguishing those visits in which all portions were seen and every part of the building viewed, from visits of Partial Inspection	and stating the Official Position of the Visitors							
	By the Governor or Colonial Secretary		By a Government Inspector		By a Committee of the Governing Body		By an Inspector specially appointed to ascertain the economical economy or otherwise of the Patients	
	By Appointment	By Surprise	By Appointment	By Surprise	By Appointment	By Surprise	By Appointment	By Surprise
1. Complete Inspection...	One by H. E. the Governor.		The Comptroller of Charit. Institutions frequently visits the Asylum by appointment and by surprise. The Chief Govt. Medical Officer visited the Asylum once a month.		A Board inspects the Asylum once every week.		This duty is performed by the Visiting Physician who attends three times a week. A Board meets weekly to admit and discharge patients.	
2. Partial Inspection ...	One by H. H. the Lieut. Governor.							

State how many reports of the following kinds have come under the notice of the Governor:—

(I.) Financial and Statistical (showing, amongst other things, on what system the Money and Store Accounts are kept and audited).

(I.) The Comptroller of Charitable Institutions renders his Money Accounts, monthly to the Auditor General, and a Store Account, annually, in the form prescribed by the Colonial Regulations.

(II.) Reports by the person or persons charged with the immediate management of the Asylum.

(II.) The officers in charge of the Asylum send weekly, monthly, quarterly and annual statistical returns and monthly financial reports to the Comptroller of Charitable Institutions as also several other reports regarding the management of the Asylum.

(III.) Reports by an Official Inspector independent of the Governing body of the Asylum.

(III.) The Comptroller of Charitable Institutions performs this duty, and reports to Government the result of his inspection, when necessary.

Question I. (Statistical).
GENERAL STATISTICAL TABLE.

Remaining on 31st March 1906.		Number admitted during above period	Daily average Number during above period	Number of Attendants		Discharged				Total	Remaining on 31st March 1907.
Sex	No.			Resident	Non Resident	Attainment of age	Withdrawn	For treatment	Dead		
Males	36	7	41	4	6	2	1	—	—	3	40
Females	44	4	44	^a 7	2	3	—	—	1	4	44
Totals	80	11	85	11	8	5	1	—	1	7	84

* Sisters of Charity who perform duty in Female Division.

SPACE AND ACCOMMODATION TABLE.

Description of Rooms	Number of such Rooms	Gross cubic space of all such Rooms	Gross superficial area of all such Rooms	Average amount of cubic space available for each inmate	Average temperature		Amount of Window Space
					Summer	Winter	
Dormitories [Male Division]	3 (Infirmary included)	Feet 98,662	Square Feet 4,732	Feet 2,406	90	48	Square Feet 575
Do. [Female Do.]	1	106,299	4,572	2,416	90	48	472
Day Room [Male Do.]	1 (Chapel included)	114,174	5,677	2,785	90	48	525
Do. [Female Do.]	4	164,072	6,936	3,729	90	48	574
Yards of play grounds [Male Do.]	2	—	2,747	—	—	—	—
Do. [Female Do.]	1	—	4,953	—	—	—	—

What is the source of Water Supply; the quality of the water; and the amount of water available for each patient every day?

The potable water is conveyed from a natural spring to a storage reservoir at about $4\frac{1}{2}$ miles from the town, and thence by an iron main to the Asylum. The second quality water is pumped from a natural spring at about three miles from the town to a feeding tank in Valletta, and thence distributed through iron pipes. Any quantity is available, as the building is directly connected with the aqueducts.

What is the Number of (I.) Lavatories?

- (II.) Baths?
(III.) Latrine?

Two sets (earthenware basin fixed on marble slabs) one in each division.

Two. Porcelain.

Two. Six Crown basins with waste water preventors. (Three in each division).

What is the system of Sewerage?

Water system. The privies are separated from the Wards by ventilated anterooms.

ORPHAN ASYLUM RETURN, for the year 1906-1907.

Question II.

Daily average number of inmates who were apprenticed to Trades and Industrial Occupations during above period.

Sexes	Occupation and number of inmates who, on discharge, obtained employment			
	Household work &c.	Apprentices in Trades		Number of those who, on discharge, obtained employment
		In the Asylum	Out of the Asylum	
Males	All the boys by turn.	1	4	Males—one shoemaker, one carpenter, and one printer.
Females	Washing, ironing, sewing, cooking and dress-making by turn.	24	—	Females — None

Question III. (Diet).

Dietary Table.

Bread 20 oz.—Meat oz. $\frac{3}{4}$ —Paste or Rice 2 oz.—Vegetables 1 $\frac{1}{2}$ ration

Milk pint $\frac{1}{2}$ —Coffee* pint $\frac{1}{2}$ —Sugar oz. $\frac{2}{3}$ —Fruit rations 2

Wine for Orphans employed in trades or household work oz. 4—Bread 5 oz.—Fruit 1 ration.

* Tea is now given instead of Coffee.

Question IV. (Inspection).

Number of Visits of Inspection paid to the Asylum during the above period.

Distinguishing those visits in which all inmates were seen and every part of the building visited, from visits of Partial Inspection	and stating the Official Position of the Visitors								
	By the Governor or Colonial Secretary		By a Government Inspector		By a Committee of the Governing Body		By an Inspector specially charged to ascertain the state of health of the inmates		
	By Appointment	By Surprise	By Appointment	By Surprise	By Appointment	By Surprise	By Appointment	By Surprise	
1. Complete Inspection ...	One by H. E. the Governor.		The Compt. of Char. Inst. visits often the Asylum by surprise.		Once by the Commissioners of Charity.				This duty is performed by a Medical Attendant who visits the Asylum once a day, and oftener when required.
2. Partial Inspection ...	One by H. H. the Lieut. Governor.		The Chief Govt. M. Officer visited the Asylum four times.						

Table with multiple columns and rows, containing faint text and numerical data. The table is mostly illegible due to fading and bleed-through from the reverse side of the page.

LUNATIC ASYLUM.

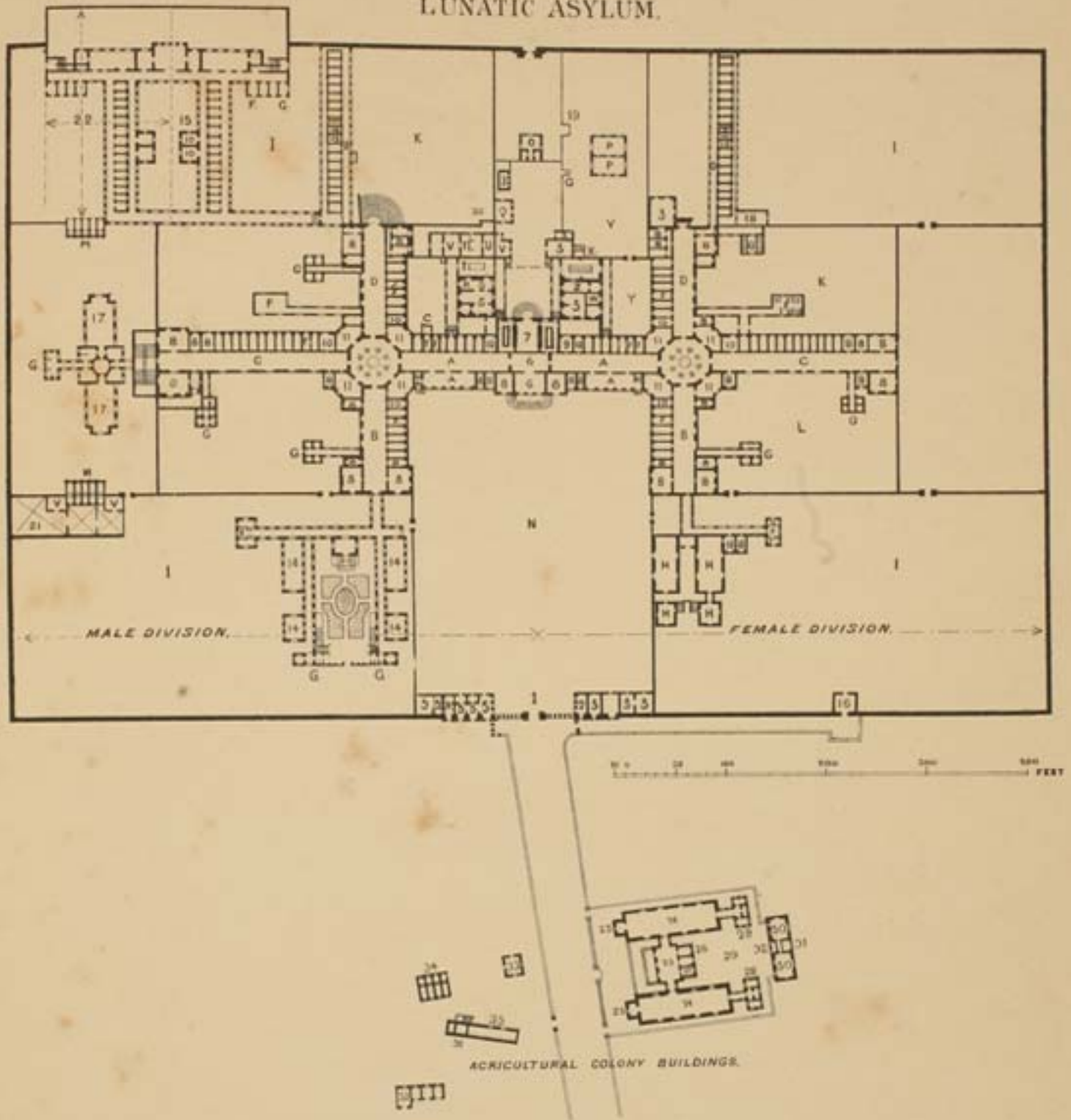

- A. Refectory for Wards Nos. 1 & 3.
- B. Gallery, refectory and bed-room for epileptics.
- C. Gallery and bed-room for quiet and convalescent patients.
- D. Gallery and refectory for criminal and violent patients.
- E. Day room.
- F. Bath rooms and lavatory.
- G. W. C.
- H. Infirmary.
- I. Open space.
- K. Court for dangerous & violent patients.
- L. Court for quiet & convalescent patients.
- M. Foultry house.
- N. Main yard.

- O. Douche apparatus.
- P. Covered yard.
- Q. Cook's room.
- R. Scullery.
- S. Store.
- T. Kitchen.
- U. Bakery.
- V. Steam engine.
- W. Store.
- X. Wash house.
- Y. Yard.
- Z. Store.
- 1. Main entrance.
- 2. Gate keeper's room.
- 3. Workshop.
- 4. Mortuary.
- 5. Storekeeper's quarters.

- 6. Entrance Hall.
- 7. Superintendent's office.
- 8. Dormitory.
- 9. Dispensary.
- 10. Attendant's room.
- 11. Observation Dormitory.
- 12. Padded room.
- 13. Store.
- 14. Infirmary.
- 15. Criminal ward.
- 16. Mortuary.
- 17. Observation ward.
- 18. Guard room.
- 19. Store.
- 20. Bakery.
- 21. Goat-shed.
- 22. Observation ward in course of construction.

- AGRICULTURAL COLONY BUILDINGS.
- 23. Day room.
 - 24. Dormitory.
 - 25. Attendant's room.
 - 26. Store.
 - 27. Head attendant's room.
 - 28. W. C., Lavatory and Bath.
 - 29. Airing court.
 - 30. Refectory.
 - 31. W. C. and Lavatory.
 - 32. Boiler room and Scullery.
 - 33. Land labourer's room.
 - 34. Pigsty.
 - 35. Cow-shed.
 - 36. Watch room.
 - 37. Stable.

