

Y

GOVERNMENT HOUSES.

1911-1912.

HOUSES OCCUPIED AS

Name and Situation	Number and size of			What is the heating and lighting arrangement and at whose cost?	Amount and description of	
	Reception Rooms	Family Rooms	Servants' Rooms		Land	Garden
Valletta Palace	No. 8 Ante Room 35'-4" x 33'-1"	No. 1 Spare Room 27'-4" x 17'-8"	No. 22 One Room 18'-6" x 13'-5"	Heating by coals which are supplied at the Governor's expense. Lighting by Electricity is paid by the Government as regards the Public and by the Governor as regards the private apartments.	Nil.	Nil.
	No. 9 State Drawing Room 35'-10" x 35'-2"	No. 2 Spare Room 28' x 18'	No. 23 One Room 18' x 13'-6"			
	No. 10 Ball Room 84'-10" x 37'-3"	No. 4 Spare Room 23'-7" x 19'-2"	No. 32 A.D.C.'s Servants' Room 19'-10" x 9'-7"			
	No. 11 Dining Room 66'-10" x 28'-6"	No. 15 His Excellency's Room 24'-2" x 21'-5"	No. 33 One Room 21'-2" x 14'-3"			
	No. 12 Day Room 17'-3" x 16'-10"	No. 16 His Excellency's Room 25' x 20'-4"	No. 34 One Room 20'-6" x 14'-2"			
	No. 13 Day Room 17' x 16'-4"	No. 17 His Excellency's Room 24'-10" x 20'-8"	No. 35 One Room 23'-9" x 14'-3"			
	No. 14 Private Drawing Room 45'-4" x 20'-9"	No. 24 Spare Room 24' x 19'-3"	No. 36 Steward's Quarters			
		No. 25 Spare Room 24' x 19'-10"	Messenger's Quarters			
		No. 26 Spare Room 24' x 19'-6"	Fatiguedman's Quarters			
		No. 28 A.D.C.'s Room 27'-11" x 18'-11"	a. Coachman's Quarters			
		No. 29 A.D.C.'s Room 21'-9" x 15'-9"				
		No. 30 A.D.C.'s Room 29'-4" x 17'-9"				
		No. 31 A.D.C.'s Room 32'-11" x 12'-2"				

RESIDENCES BY THE GOVERNOR.

Number of Labourers and Gardeners required	Any expenses necessarily borne by Governor in 1911-12	Furniture				Other information useful for a new Governor
		If supplied by Colonial Government	Percentage annually payable	Are Plate, Linen Crockery, Glass supplied by Colonial Government?	Percentage payable	
The only Gardener employed for cultivating the Palace Yards is paid by the Colonial Government.	Nil.	Yes.	5% on certain amount	Plate, table-linen, crockery, glass and kitchen utensils are supplied by the Colonial Government.	5%	The Verdala Palace is also reserved for the Governor as a summer residence.

HOUSES OCCUPIED AS

Name and Situation	Number and size of			What is the heating and lighting arrangement and at whose cost?	Amount and description of	
	Reception Rooms	Family Rooms	Servants' Rooms		Land	Garden
St. Antonio Palace and Gardens within the limits of Casal Attard.	No. 14 Dining Room 39'-5" X 29'-6"	No. 1 His Excellency's Room 21' X 17'-4"	No. 26 Upper floor One Room 21'-1" X 19'	Heating is obtained by means of Iron coal Stoves, and Lighting by Electricity all at the expense of the Governor.	Kitchen-garden on the other side of the road of the extent of Acres 2. 6. 35.	Public Gardens of the extent of 15 acres. Private Gardens of 4½ acres.
	No. 16 Billiard Room 34'-4" X 24'-4"	No. 2 His Excellency's Room 22'-7" X 21'-5"	No. 28 One Room 15'-4" X 11'-1"			
	No. 21 Drawing Room 35'-6" X 27'-9"	No. 3 Spare Room 21'-11" X 18'-3"	No. 29 One Room 15'-2" X 11'			
		No. 4 Spare Room 22' X 19'-2"	No. 30 One Room 19'-2" X 15'-11"			
		No. 5 Bed Room 30' X 14'-3"	No. 31 One Room 19' X 10'-4"			
		No. 6 Spare Room 21'-5" X 14'-3"	No. 32 One Room 18'-10" X 16'-1"			
		No. 7 Spare Room 19' X 17'-10"	No. 33 One Room 10'-6" X 9'-2"			
		No. 8 Spare Room 20'-5" X 18'	No. 34 One Room 10'-5" X 9'-3"			
		No. 9 A.D.C.'s Room 24'-6" X 22'-5"	No. 35 One Room 18'-8" X 15'-10"			
		No. 12 A.D.C.'s Room 25'-6" X 24'-1"	No. 36 One Room 13'-5" X 10'			
		No. 18 Spare Room 24'-2" X 21'-11"	No. 37 One Room 17' X 14'-1"			
		No. 20 Spare Room 30'-10" X 24'-4"	Ground floor			
		No. 22 (Tower) A.D.C.'s Room 30'-1" X 14'-1"	No. 39 Spare Room 21'-10" X 18'-3"			
		No. 24 (Tower) Spare Room 30' X 14'-3"	No. 44 Custodian's Quarters			

RESIDENCES BY THE GOVERNOR.

Number of Labourers and Gardeners required	Any expenses necessarily borne by Governor in 1911-12	Furniture			Other information useful for a new Governor	
		If supplied by Colonial Government	Percentage annually payable	Are Plate, Linen, Crockery, Glass supplied by Colonial Government?		Percentage payable
<p>IN PUBLIC GARDENS. Five Gardeners and 10 Labourers and Apprentices and one Policeman, paid out of the Colonial Funds.</p> <p>IN PRIVATE GARDENS. Three Gardeners, 3 Labourers and 1 Cartman paid out of the Colonial Funds.</p>	Nil.	Yes	5% on certain amount		5%	<p>The cultivation of the kitchen-garden is at the charge of the Governor. A Cow-house is annexed to the kitchen-garden.</p> <p>This Palace is at present lent to the War Department for the use of the Inspector General of the Oversea Forces.</p>
				Plate, table-linen, crockery, and glass are supplied by the Colonial Government.		

HOUSES OCCUPIED AS

Name and Situation	Number and size of			What is the heating and lighting arrangement and at whose cost?	Amount and description of	
	Reception Rooms	Family Rooms	Servants' Rooms		Land	Garden
Verdala Palace situate $1\frac{1}{2}$ miles to the south, and within the limits of Notabile.	No. 4 Dining Room 20' X 21'-3"	No. 1 Lady's Room 21' X 21'-9"	No. 8 Valet's Room 10' X 10'	The heating is obtained by means of iron coal stoves and lighting by Acetylene Gas, all at the expense of the Governor.	Nil.	
	No. 5 Reception Room 45'-3" X 29'	No. 2 His Excellency's Room 21' X 21'-9"	No. 16 One Room 20'-10" X 24'-5"			
	No. 6 His Excellency's Study 20' X 21'-3"	No. 3 Spare Room 21' X 21'-7"	No. 17 One Room 11' X 11'			
	No. 7 Entrance Hall 29' X 17'	No. 10 Spare Room 27' X 22'-9"	No. 21 Dining Room 34' X 15'-6"			
	No. 9 Boudoir 28'-3" X 19'-8"	No. 12 Spare Room 24'-8" X 21'-7"	No. 27 Butler's Room 20'-4" X 19'			
	No. 13 Drawing Room 48' X 29'	No. 13 Spare Room 24'-8" X 21'-6"	No. 29 Servants' Hall 19'-6" X 19'			
		No. 14 Spare Room 24'-6" X 20'-5"	F Cook's Room 17'-7" X 16'-9"			
		No. 15 Spare Room 24'-4" X 22'-5"	H One Room 20'-10" X 15'-3"			
			I One Room 20'-10" X 7'-4"			
			J One Room 21'-9" X 17'-4"			
			K One Room 21' X 8'-8"			
			O Groom's Room 21'-8" X 14'-10"			

15 Acres planted for the most part with forest trees.

RESIDENCES BY THE GOVERNOR.

Number of Labourers and Gardeners required	Any expenses necessarily borne by Governor in 1911-12	Furniture				Other information useful for a new Governor
		If supplied by Colonial Government	Percentage annually payable	Are Plate, Linen Crockery, Glass supplied by Colonial Government?	Percentage payable	
Two Gardeners paid out of Colonial Funds.	Nil.	Yes.	5% on certain amount	Plate, table-linen, crockery, glass and kitchen utensils are supplied by the Colonial Government.	5%	

GOVERNOR'S PALACE — VALLETTA.

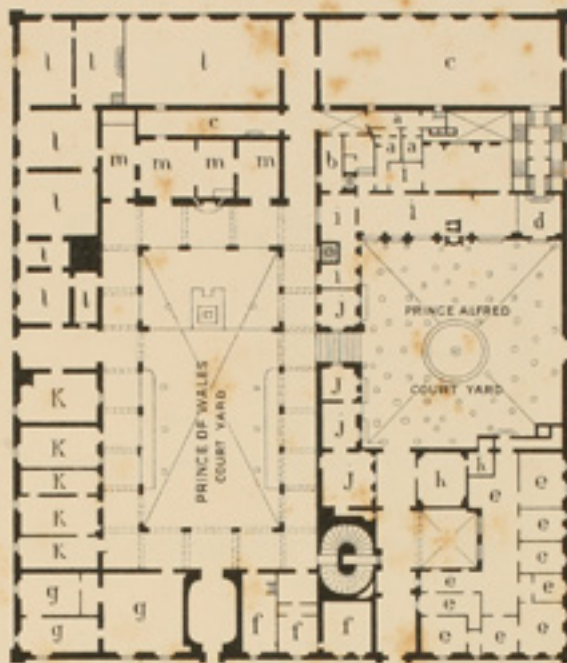

GROUND FLOOR.

- | | | | |
|----|-------------------------------|----|--|
| a. | Coachman's Quarters. | h. | Council Office. |
| b. | Harness Room. | i. | Printing Office. |
| c. | Stables and Coach House. | j. | H. E. the Governor's Office (temporary). |
| d. | Staircase to Armoury. | k. | Receiver General's Office. |
| e. | Lieutenant Governor's Office. | l. | Public Works Office. |
| f. | Crown Advocate's Office. | m. | Public Works Store Rooms. |
| g. | R. M. Regt. Mess. | | |

